

# GULLBERG *GJ* JANSSON

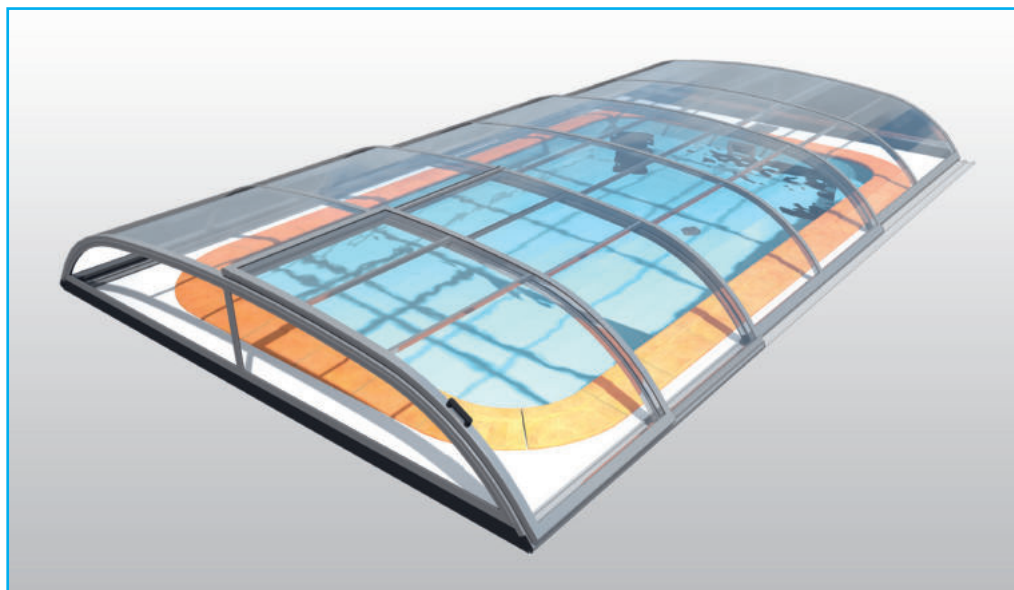

## P O O L T A K

### NOVA COMFORT & STELLA COMFORT

## Allmän Monteringsmanual

### **OBS!!**

Innan ni börjar montera ert nya pooltak så rekommenderar vi att ni går in på vår hemsida och tittar på vår monteringsfilm som kommer att vara en utmärkt hjälp för er.

**<https://www.gullbergjansson.se/produkt-kategori/pooltak>**

Välj sedan det tak ni är intresserad av och klicka på ***Läs mer***  
Här hittar ni en flik ***Video***

Rev. 2020.3.



# URLASTNING BOX

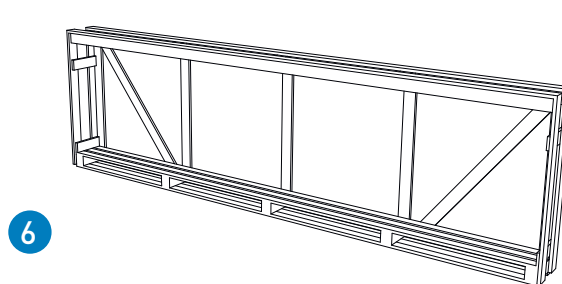
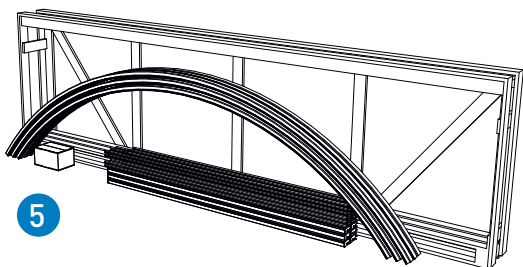
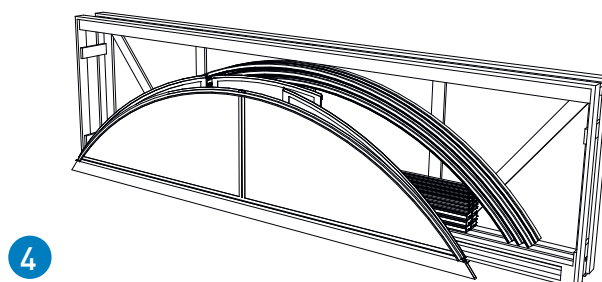
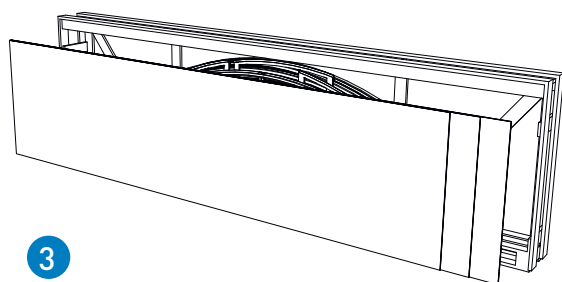
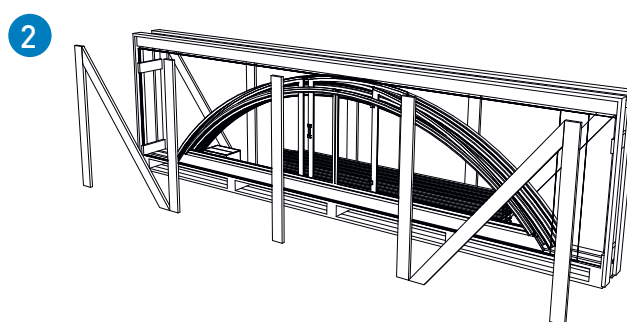
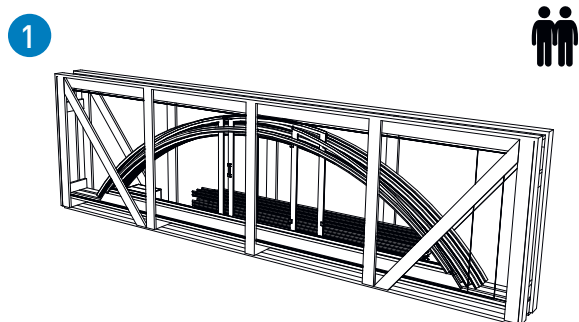
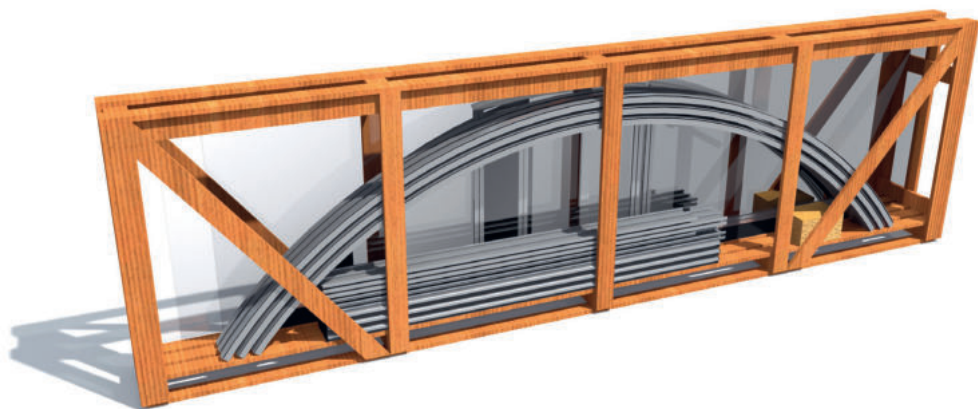

# 1 URLASTNING BOX

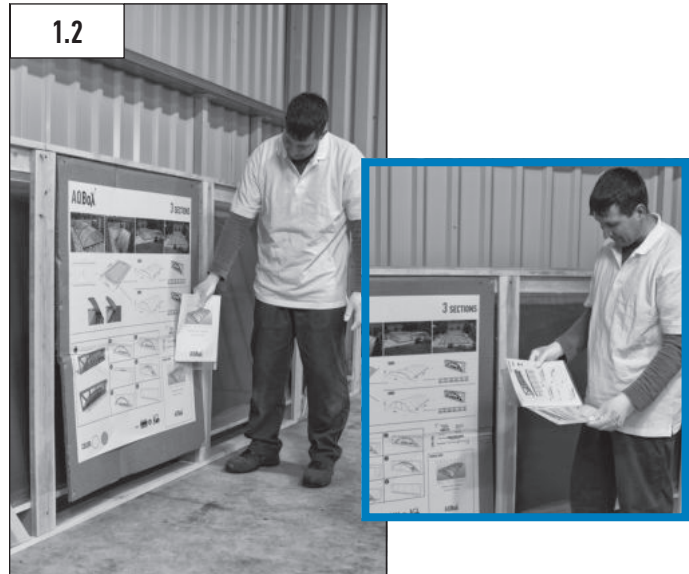

# 1 URLASTNING BOX

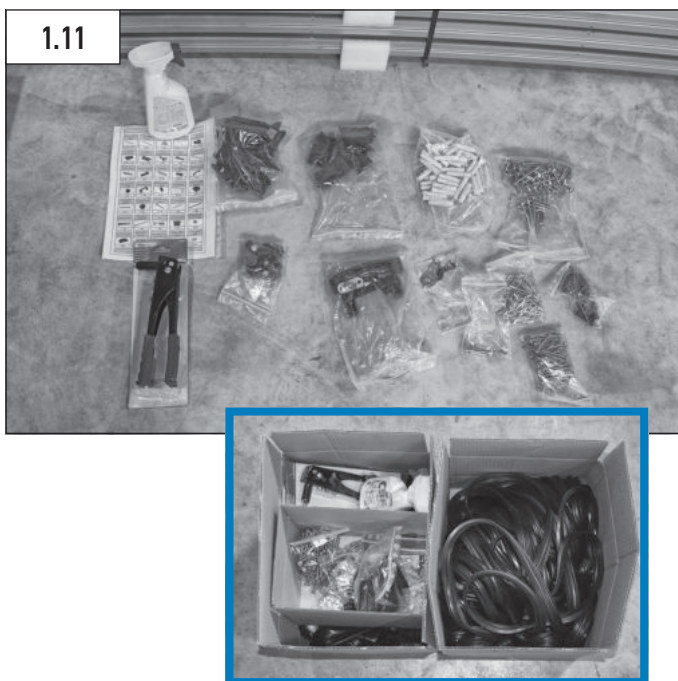
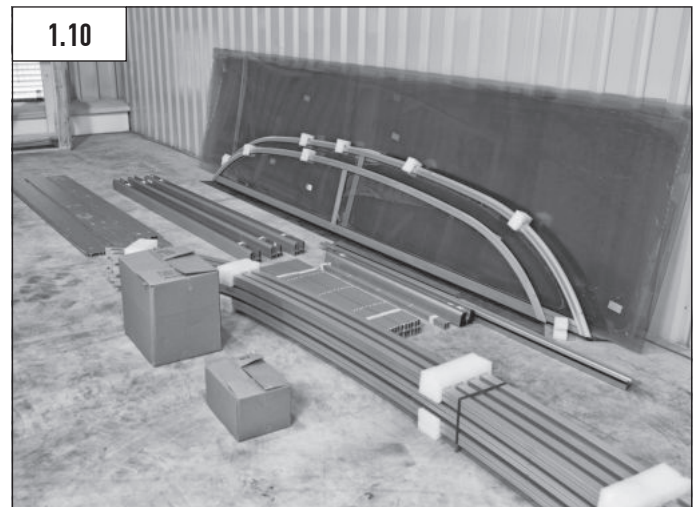

Rekommenderade verktyg (ingår ej)

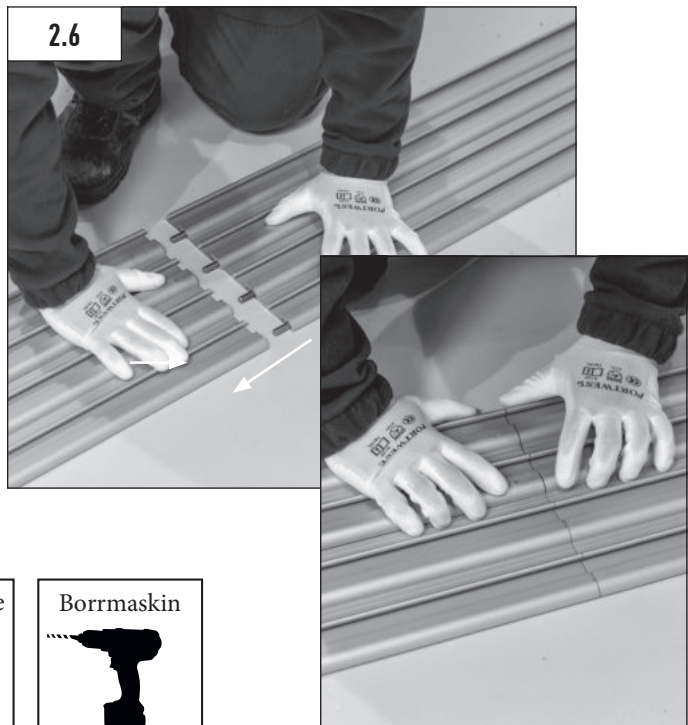
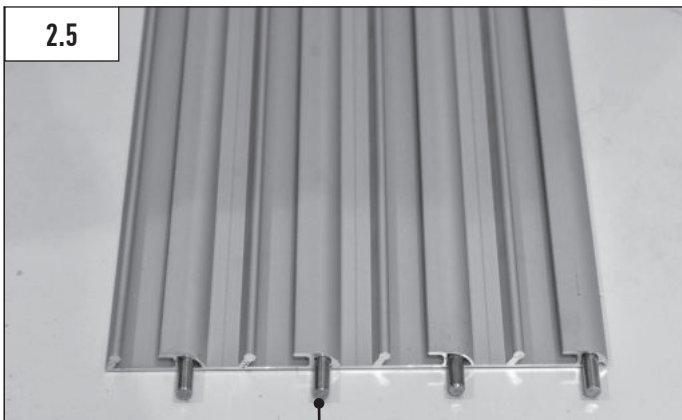
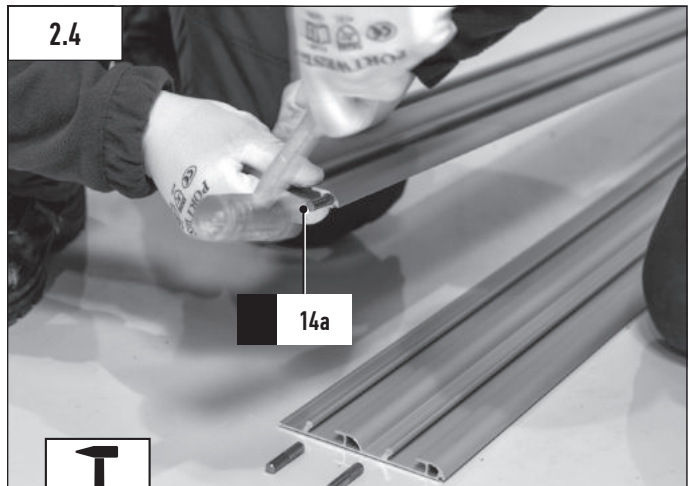
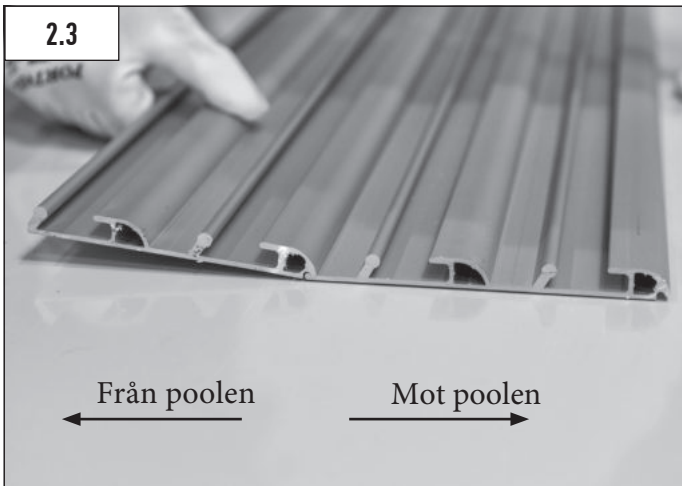

Om ni har modell A4, A3/4 eller A4S sätt inte i denna skensprinten (andra från utsidan) !

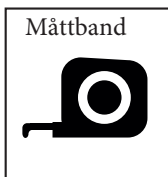

## 2 MONTERING SKENOR

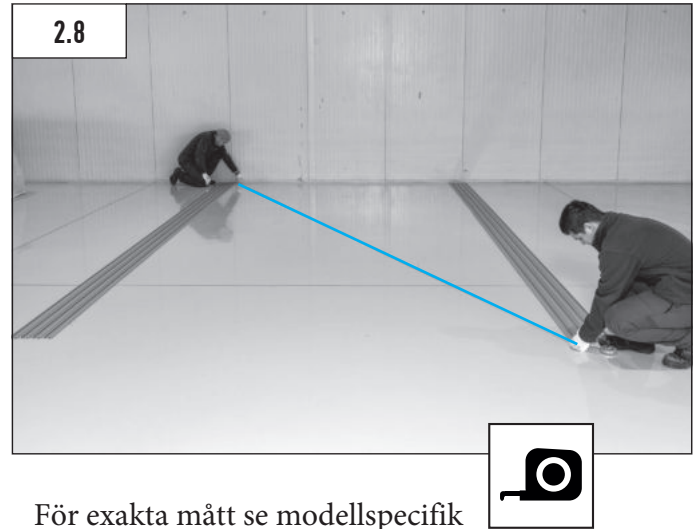

För exakta mått se modellspecifik manual!

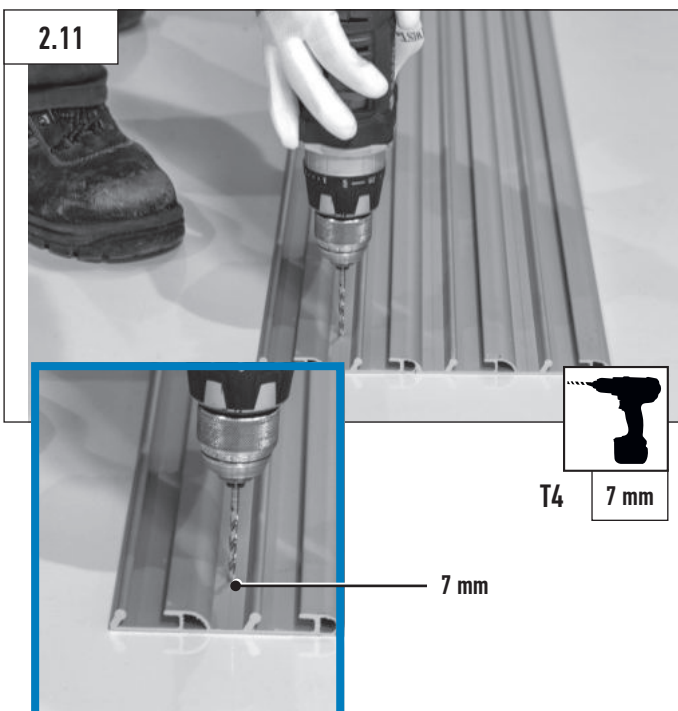
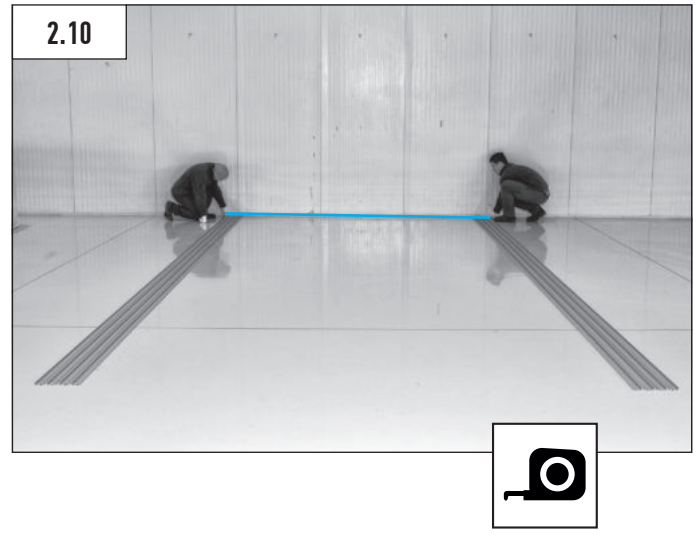
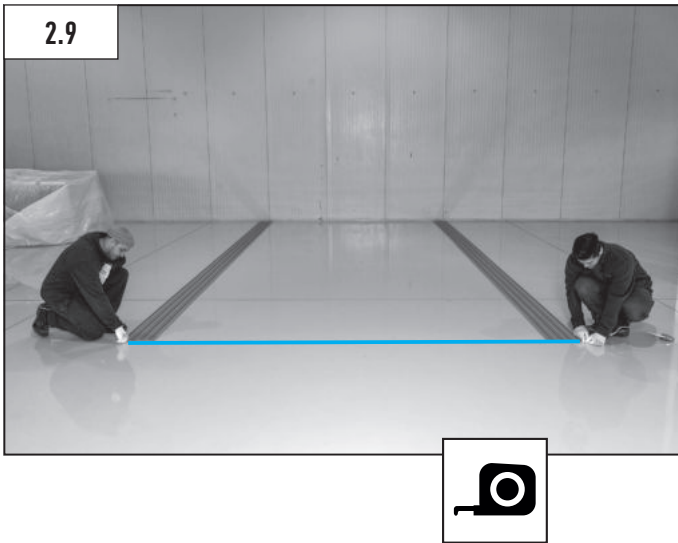

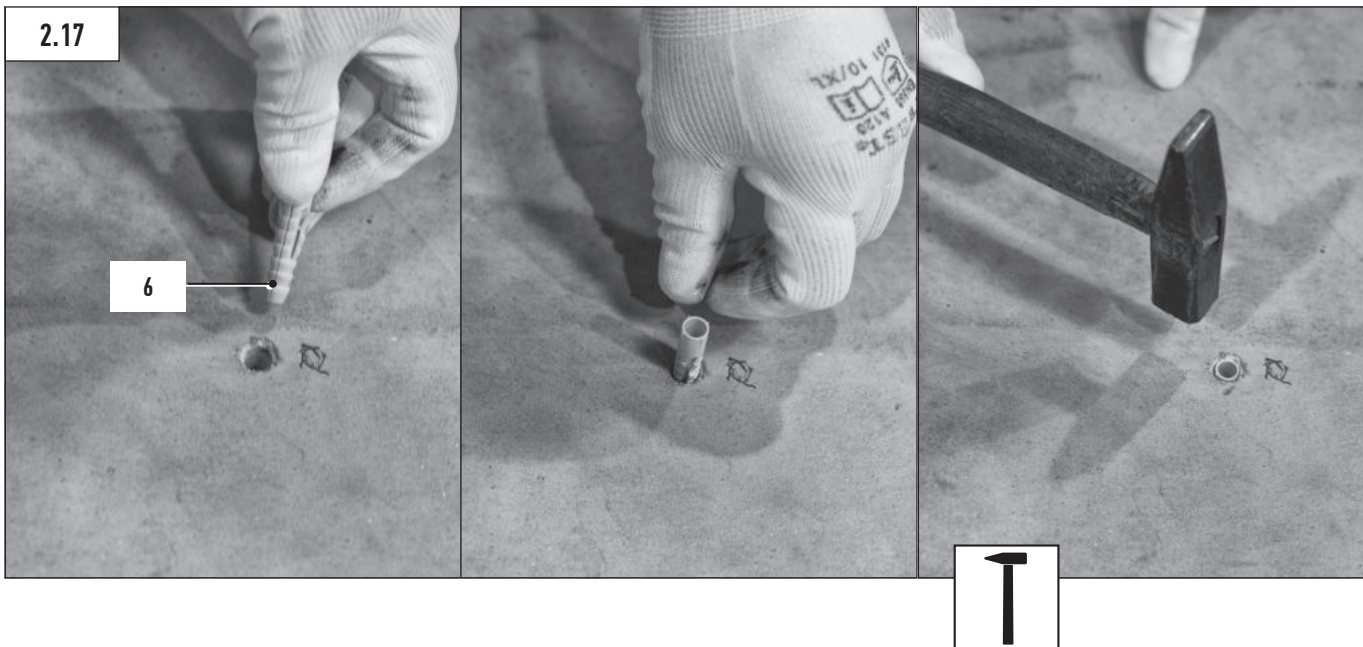
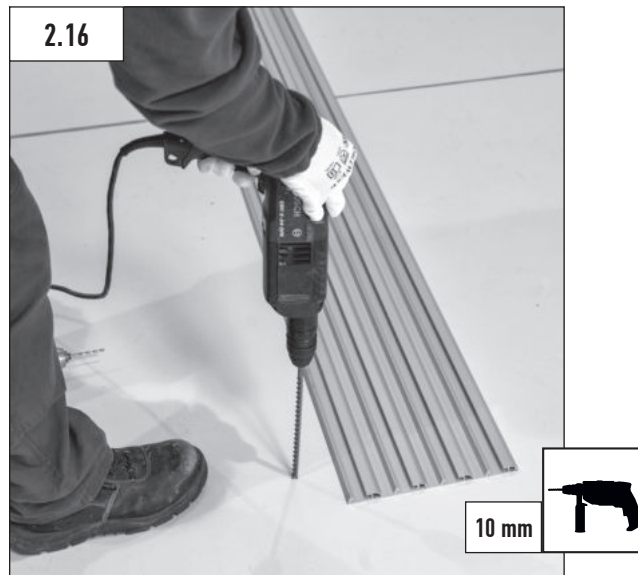
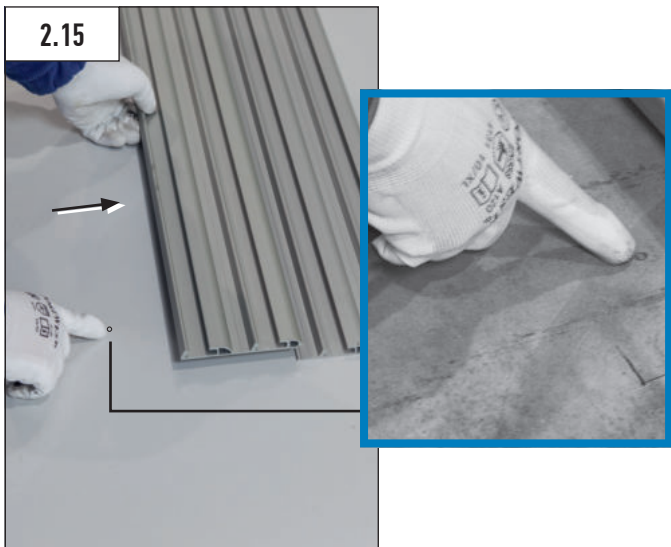
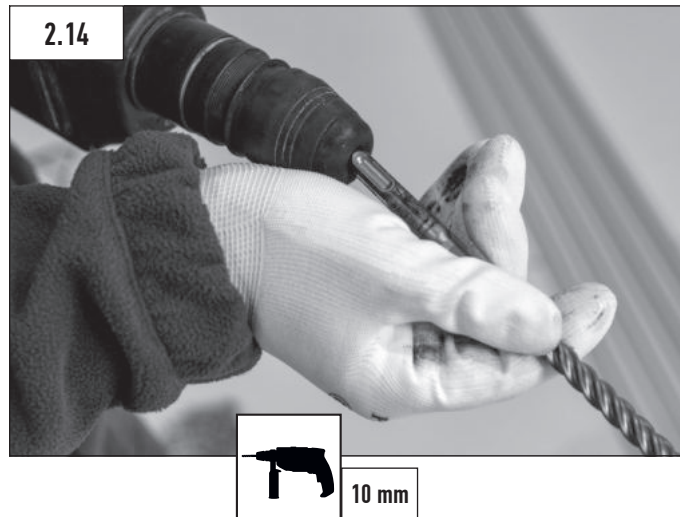



## 2 RAIL ASSEMBLY

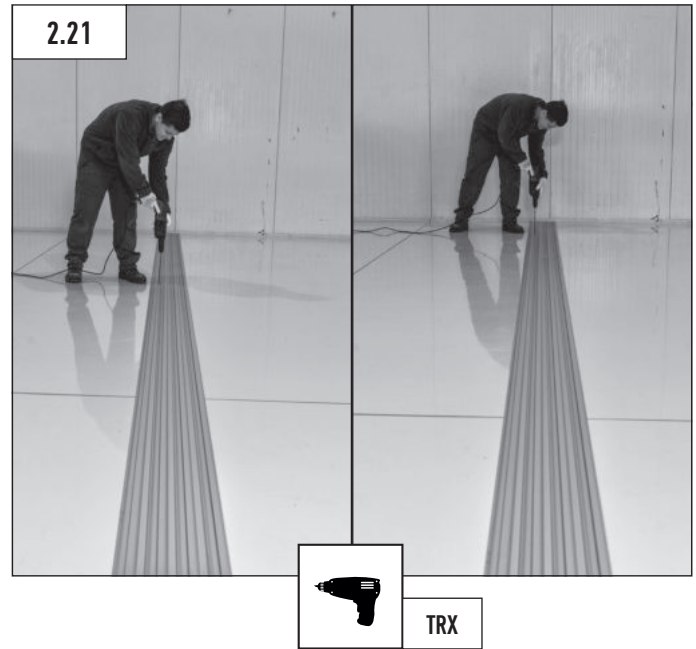
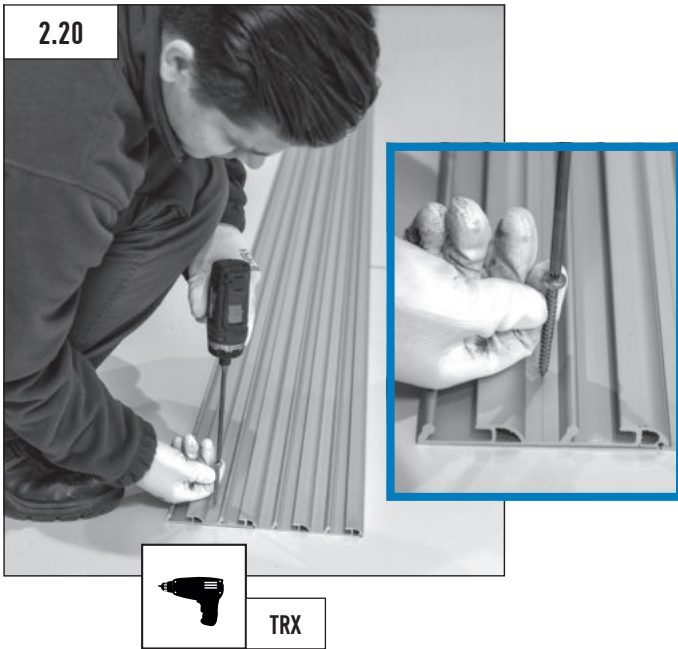
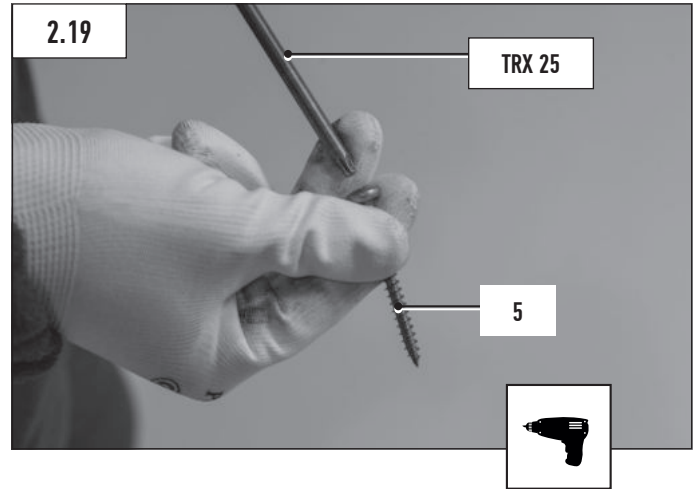

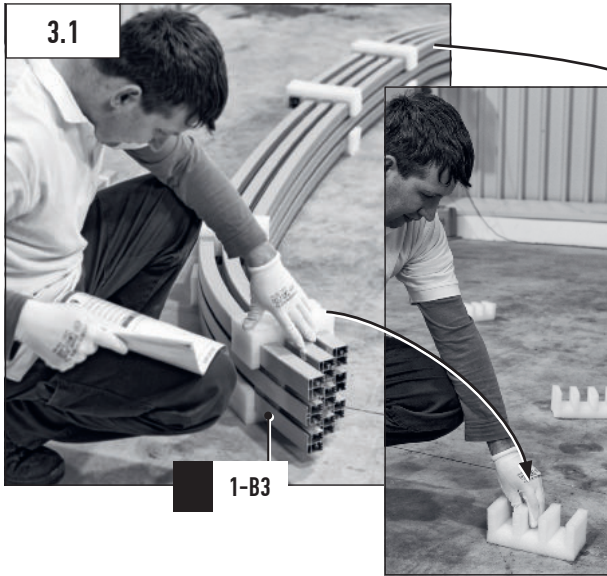

\* 1-HS=  
där dörren placeras

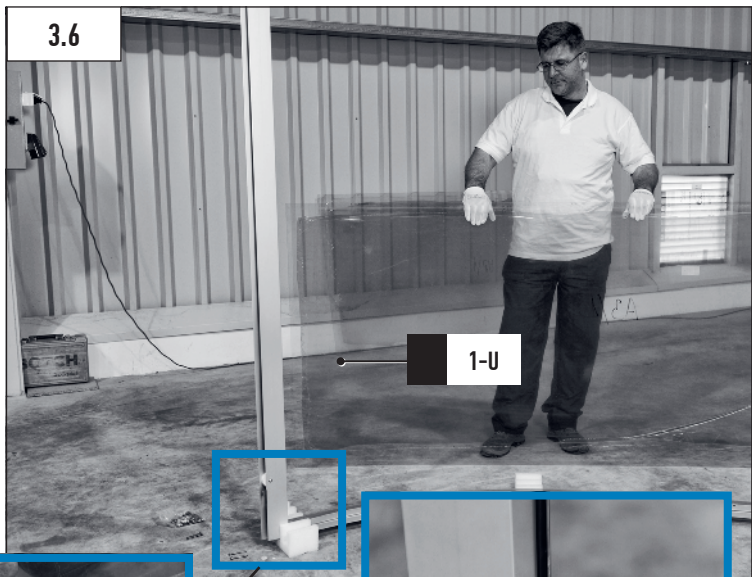
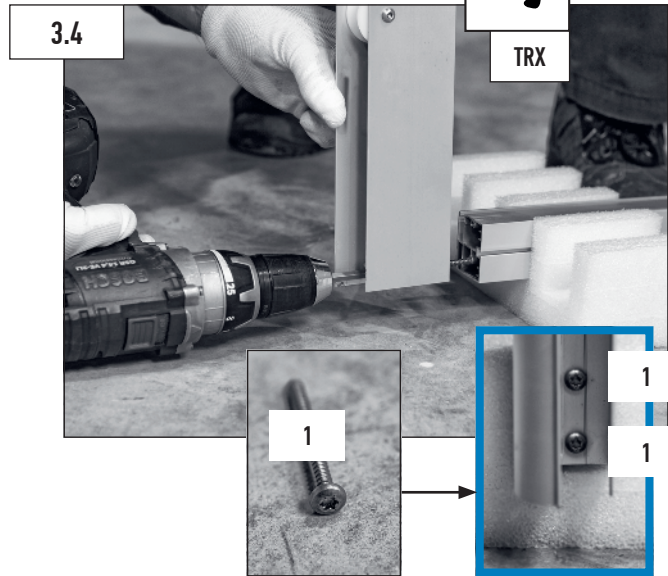
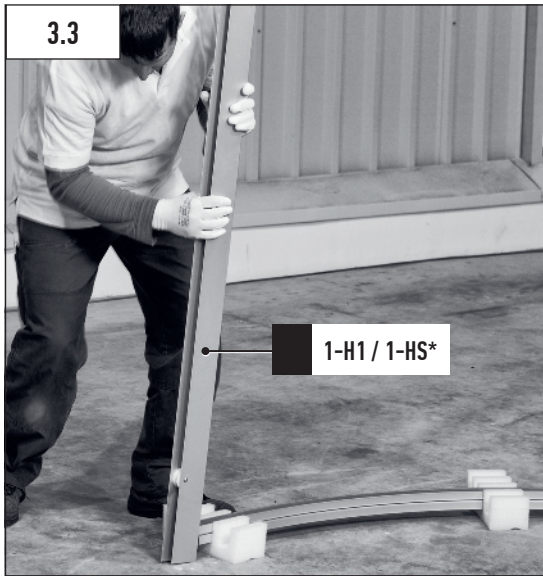

### 3 MONTERING STÖRSTA SEKTIONEN

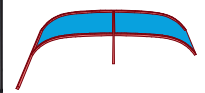
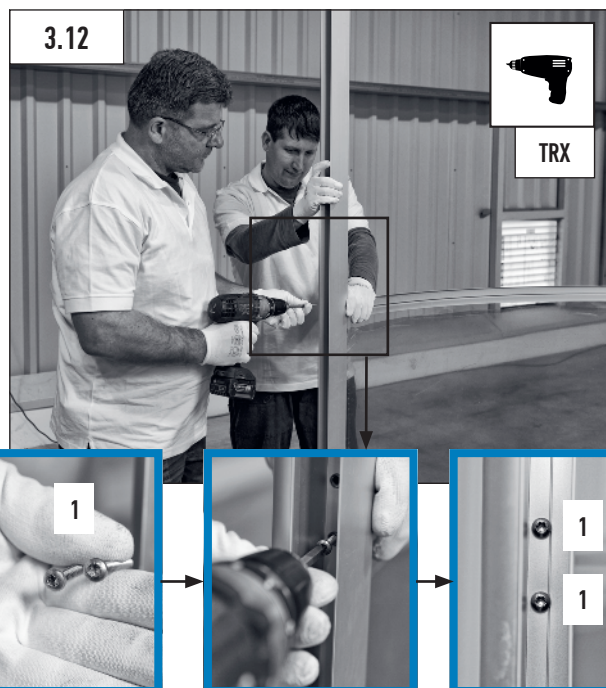
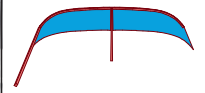
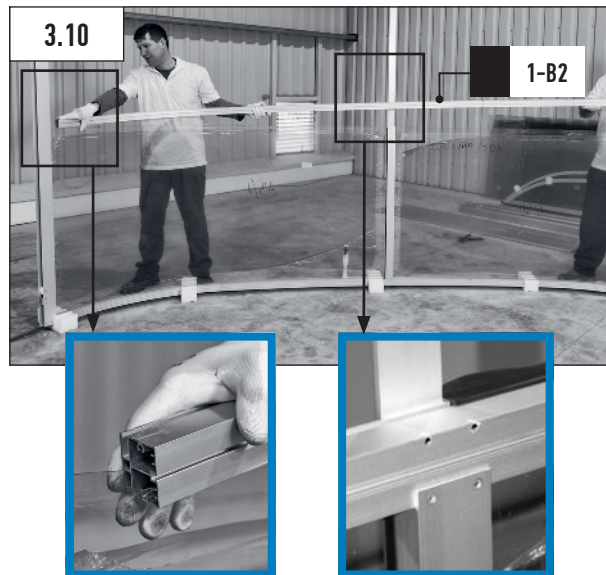
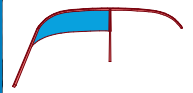

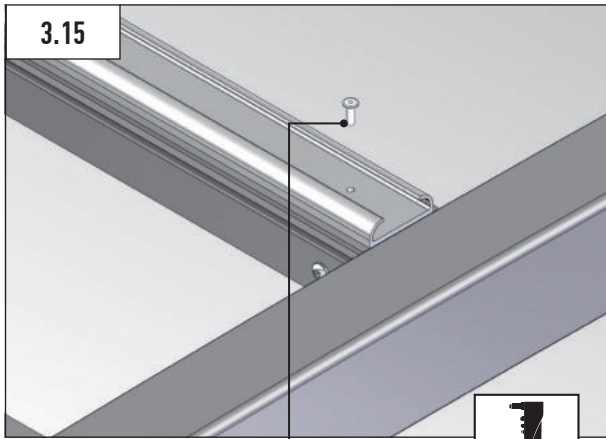
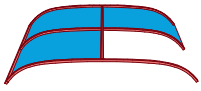
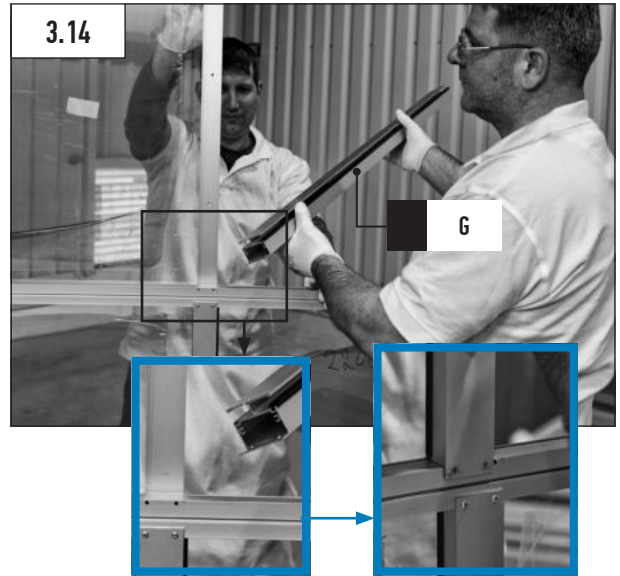
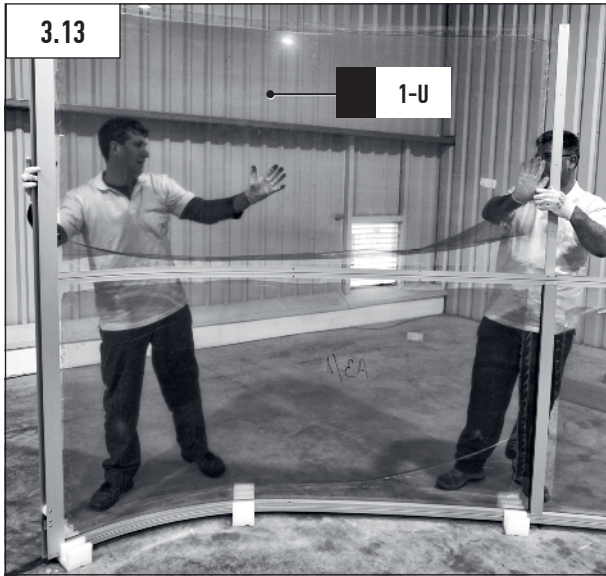
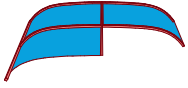

Fäst skenan till G profilen med popnit!

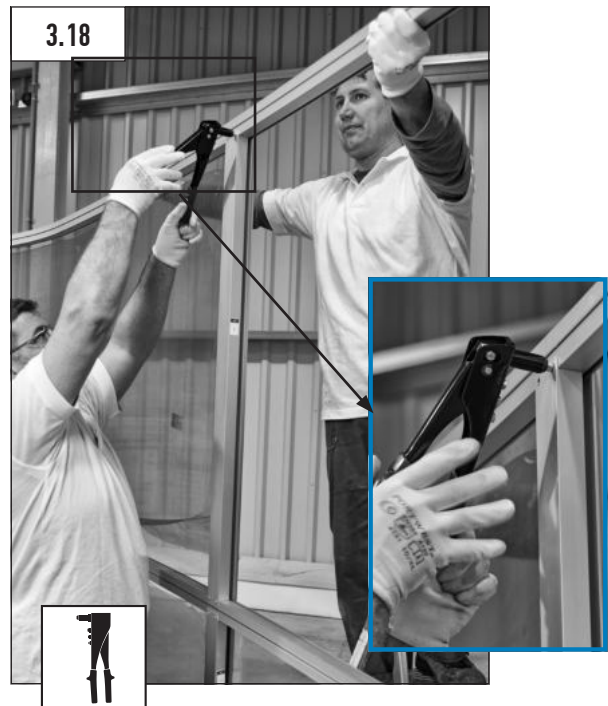
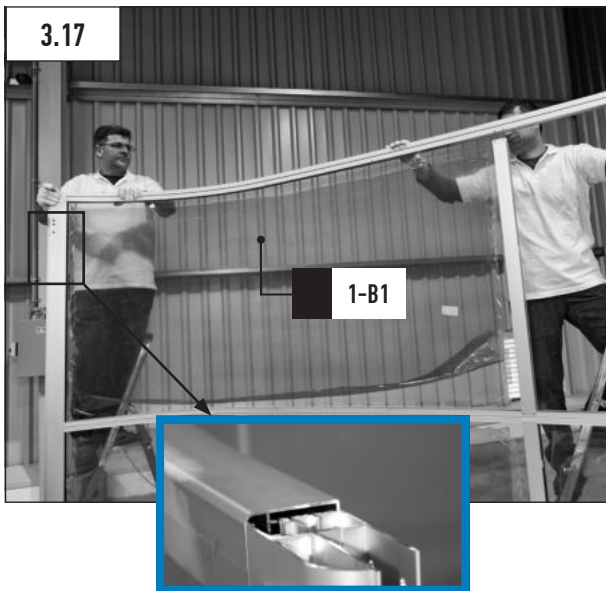

### 3 MONTERING STÖRSTA SEKTIONEN

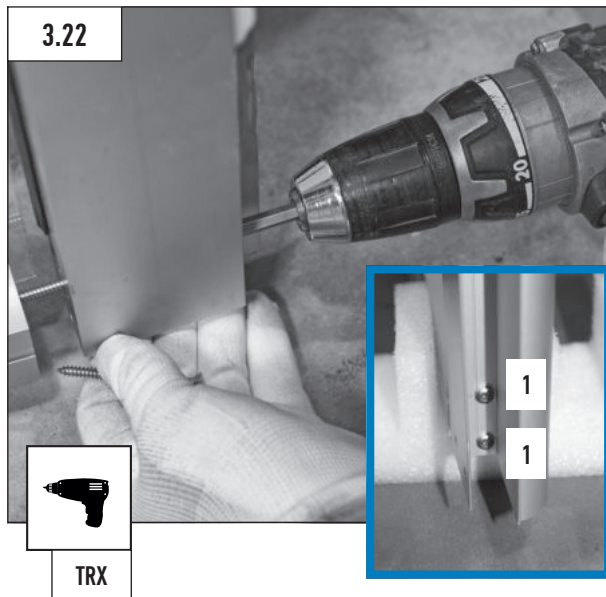
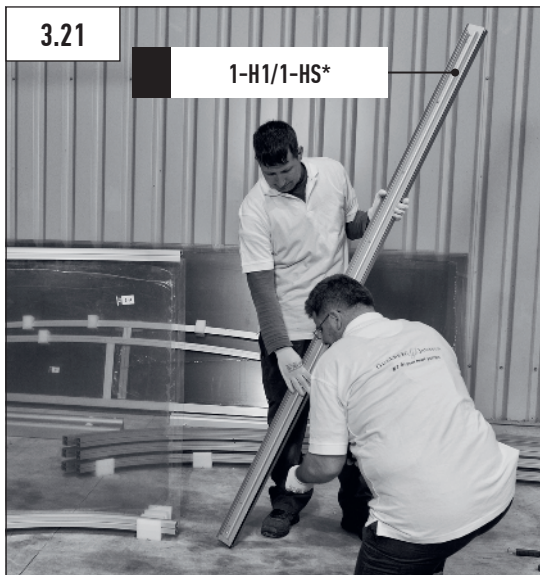
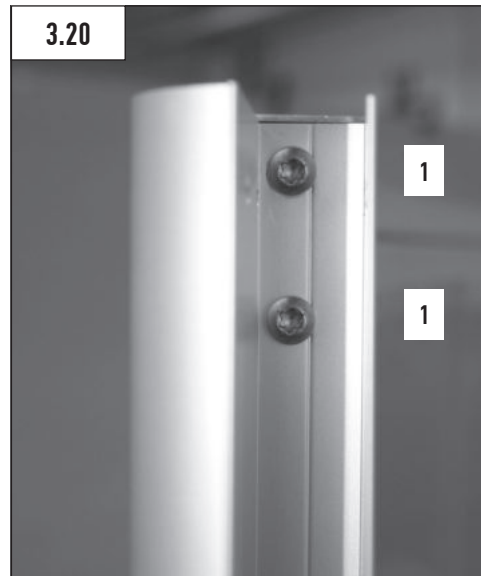
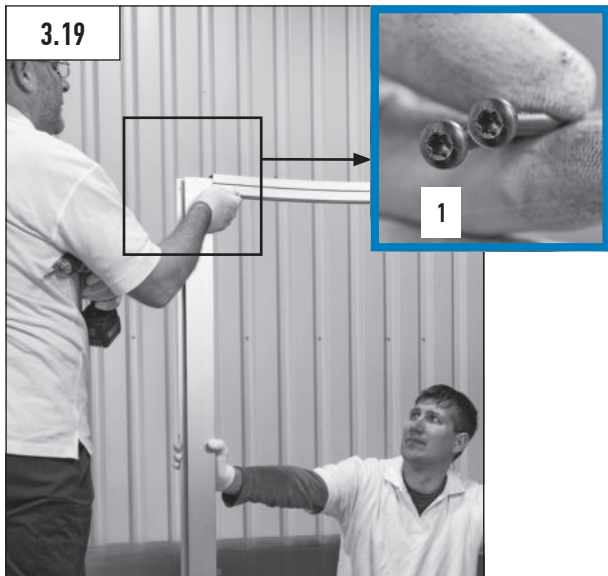

\* 1-HS=  
dörrens placering



### 3 MONTERING STÖRSTA SEKTIONEN

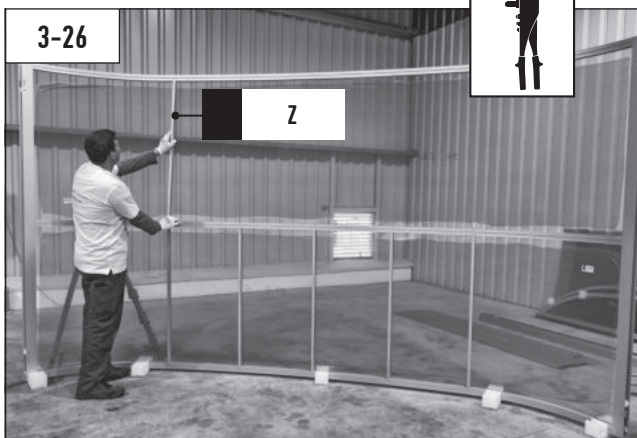

Mer information om montering Z profil på sid 20. Bild 4.17-4.18

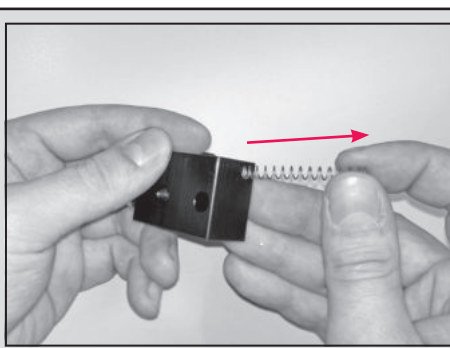
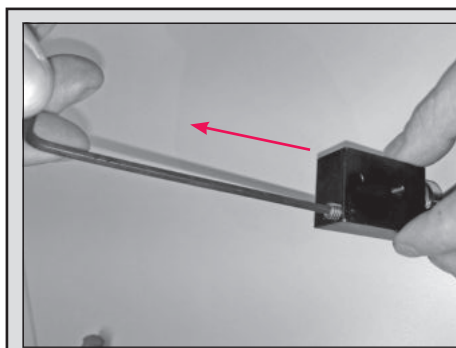

Valfritt:  
Genom att ta bort fjädern i den manuella låsningen så kommer låspinnen hamna i rätt läge på skenan vid stängning. Motsvarande sida måste då låsas manuellt när taket stängs.

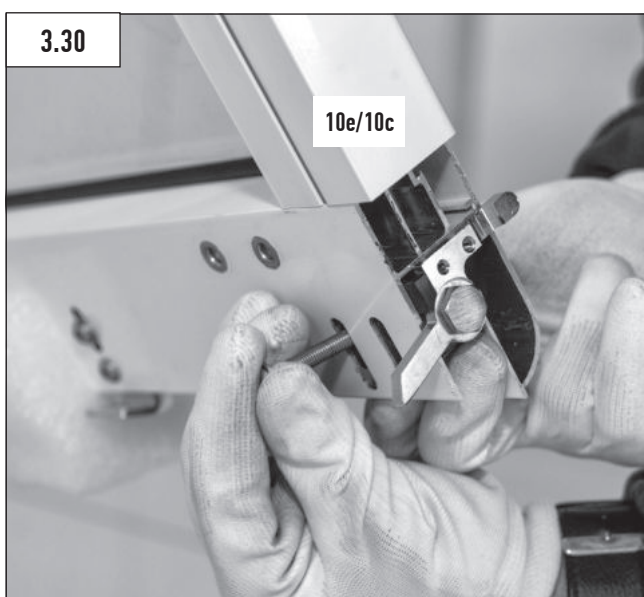
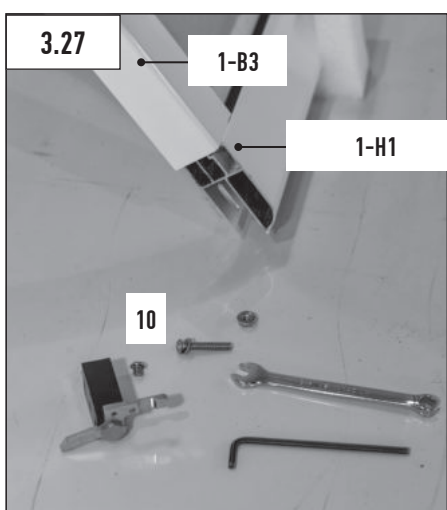

### 3 MONTERING STÖRSTA SEKTIONEN

3.32

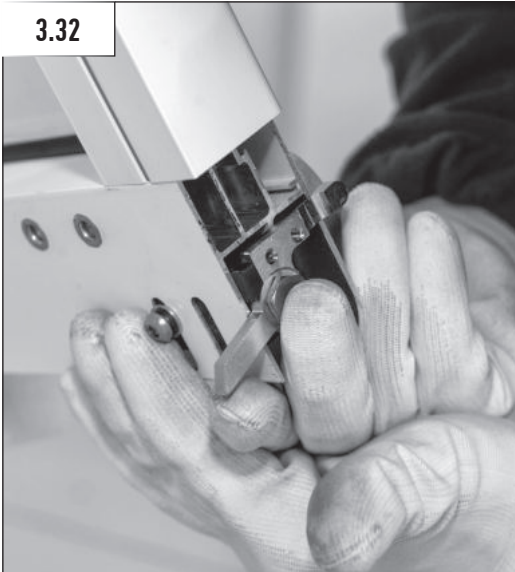

3.33

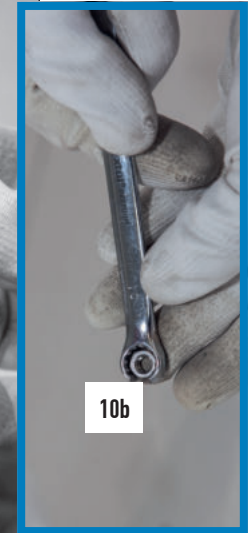

10b

3.34

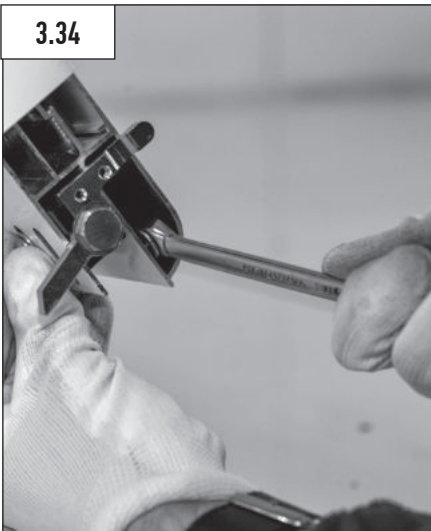

3.35



3.36

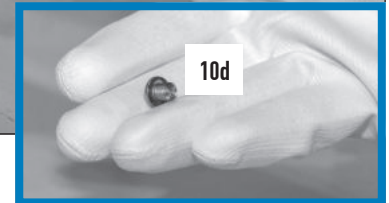
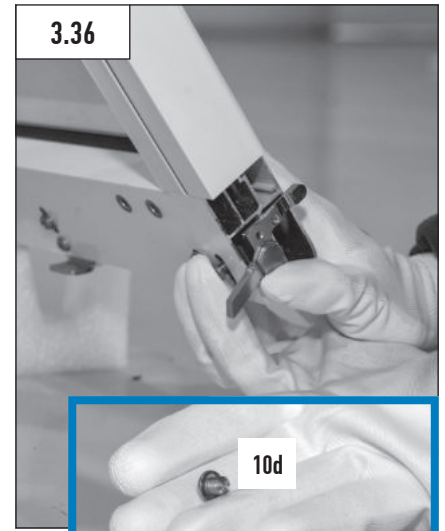

10d

3.37

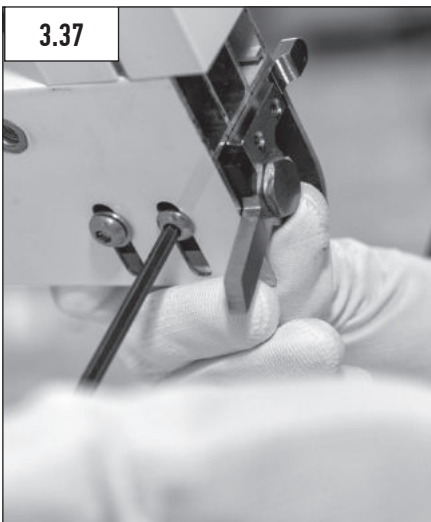

3.38

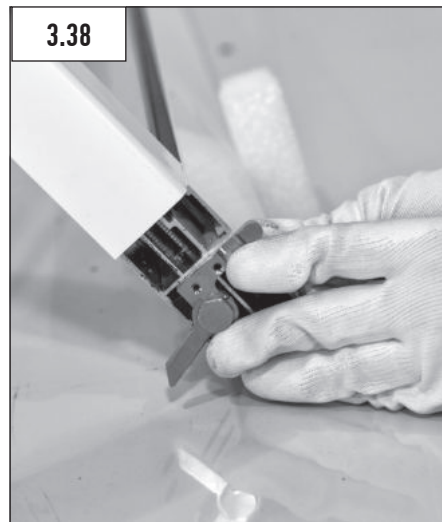

3.39

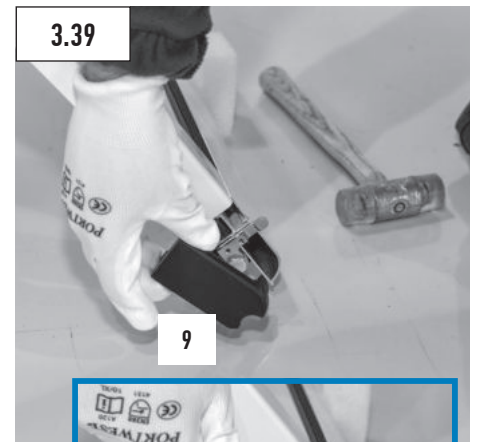

9



### 3 MONTERING STÖRSTA SEKTIONEN

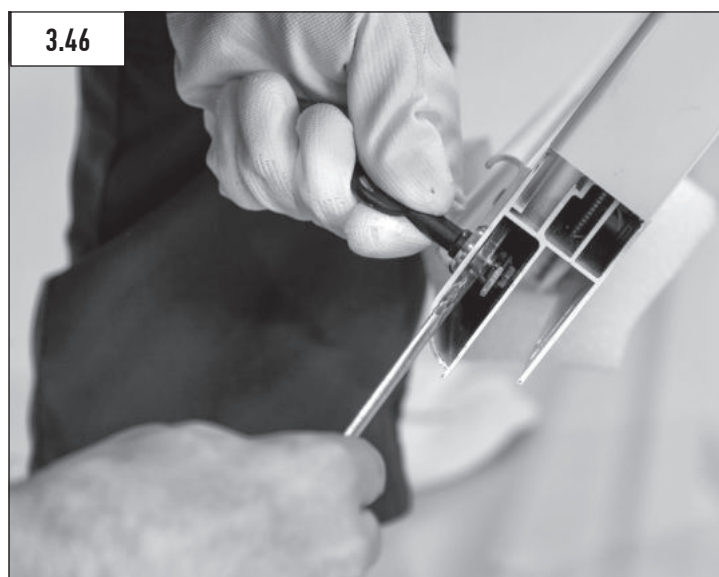
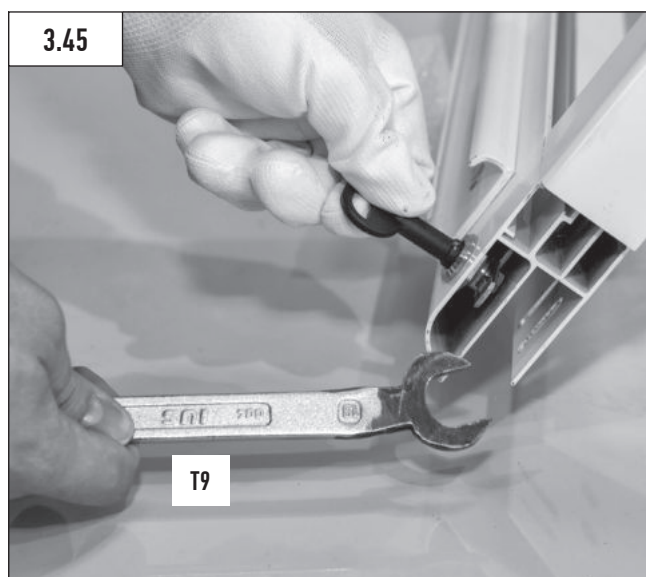
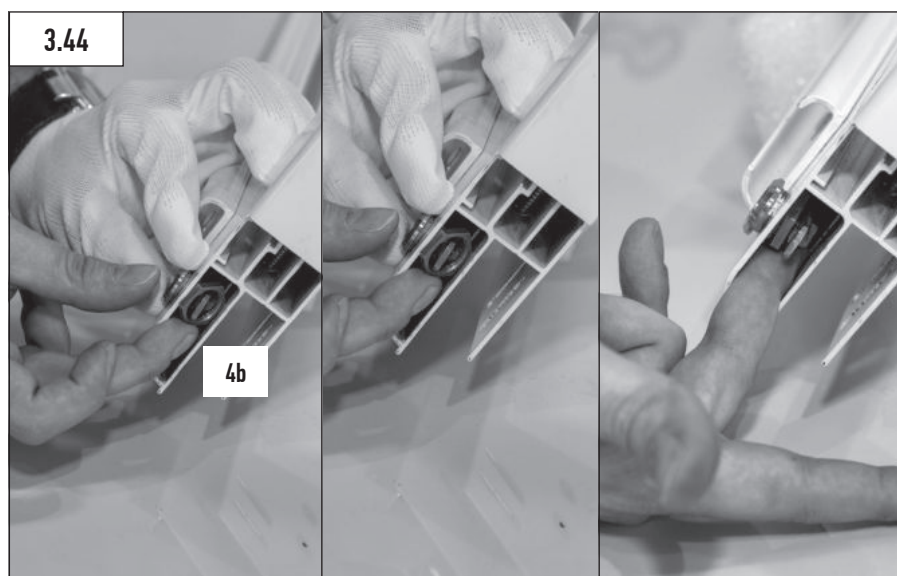
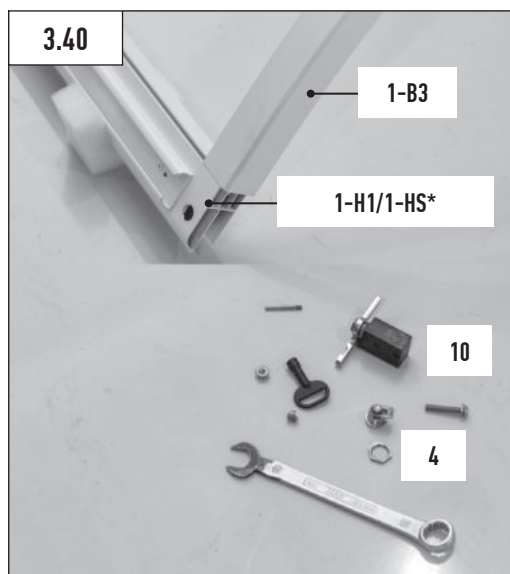

\* 1-HS =  
dörrens placering



### 3 MONTERING STÖRSTA SEKTIONEN

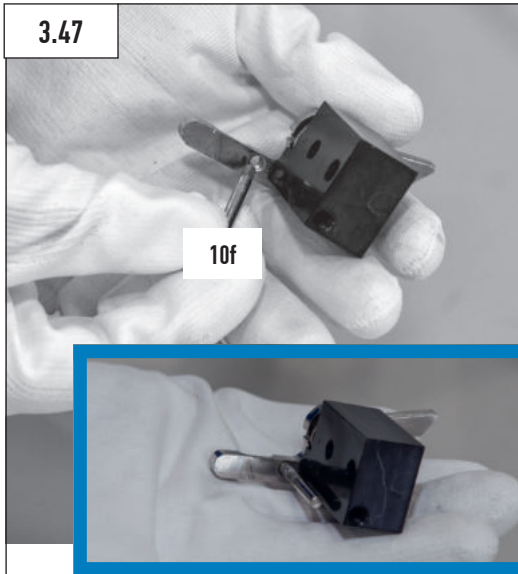

# 4 MONTERING ÖVRIGA SEKTIONER

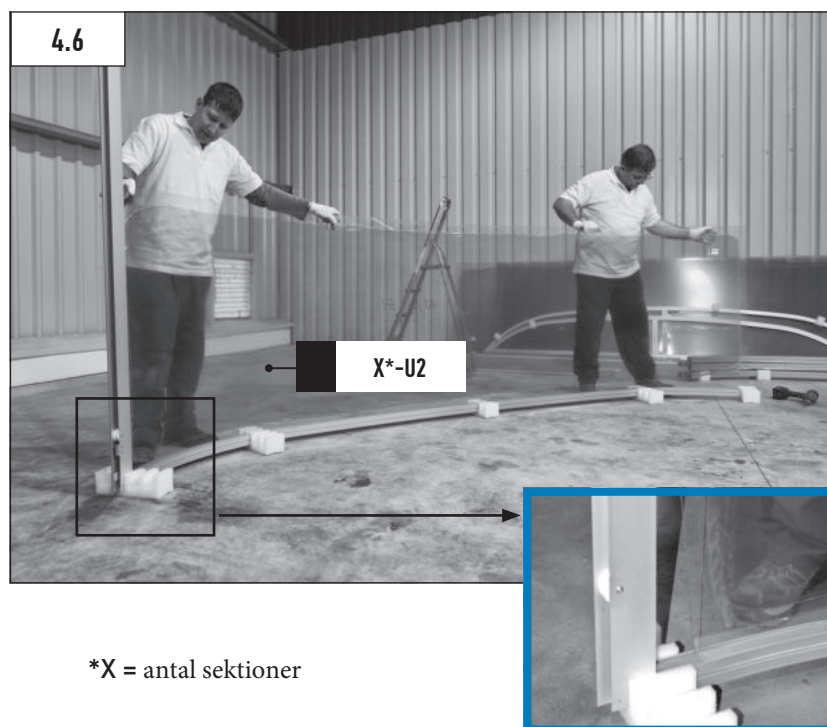
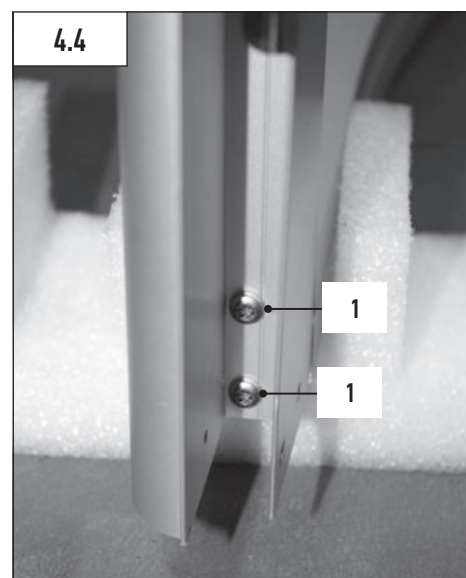
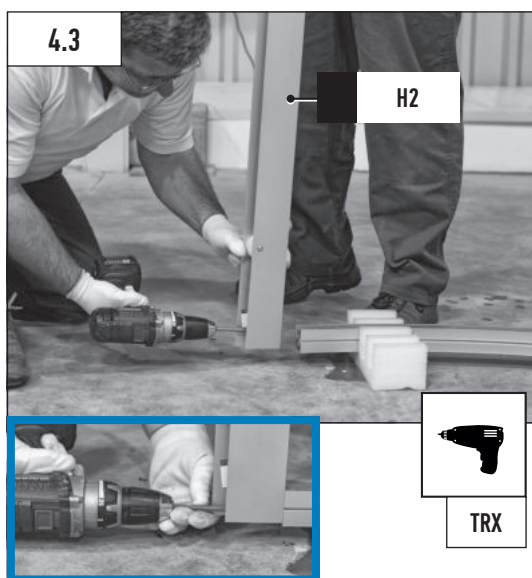
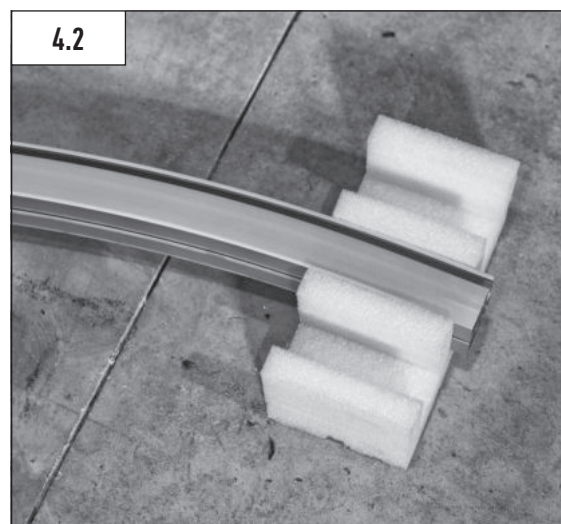
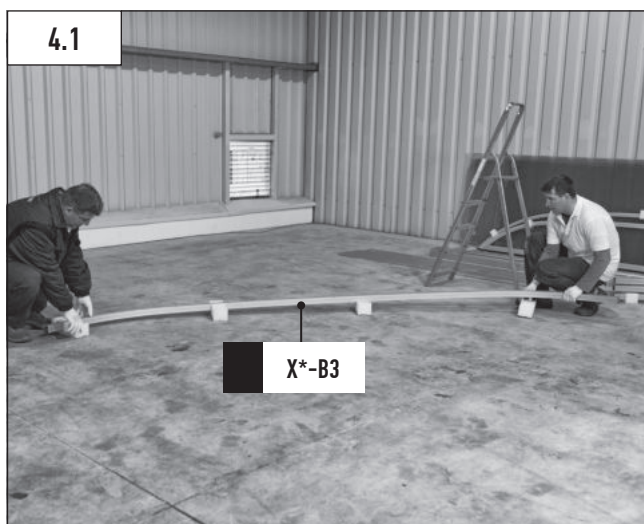

\*X = antal sektioner

# 4 MONTERING ÖVRIGA SEKTIONER

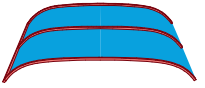
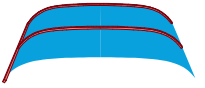
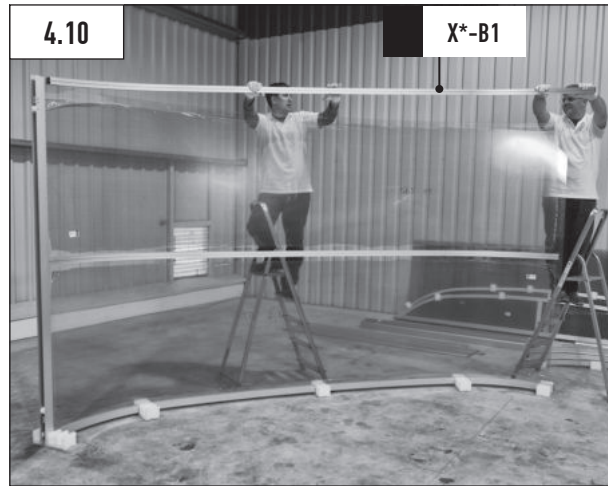
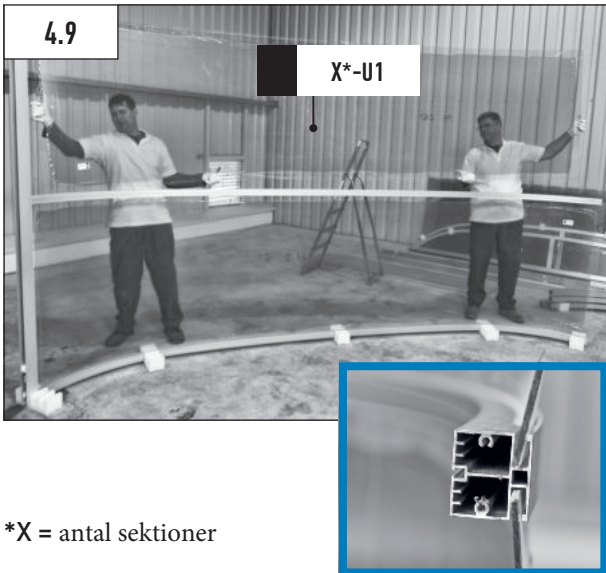
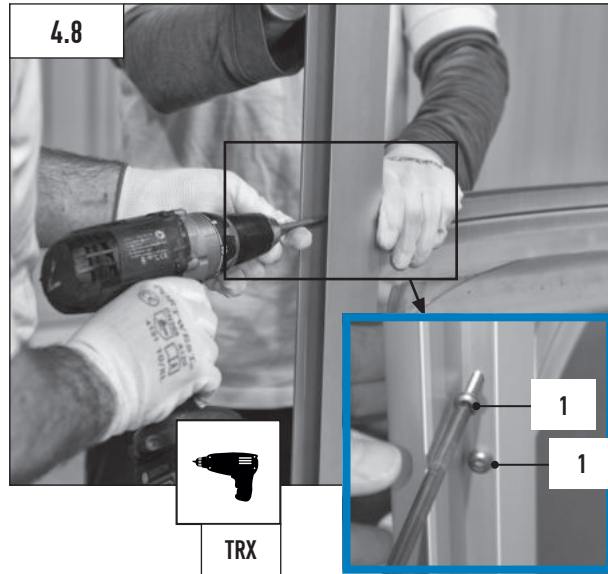
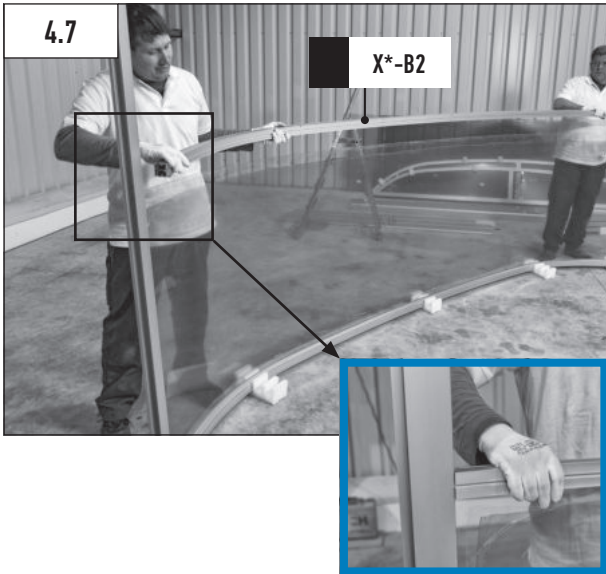

\*X = antal sektioner

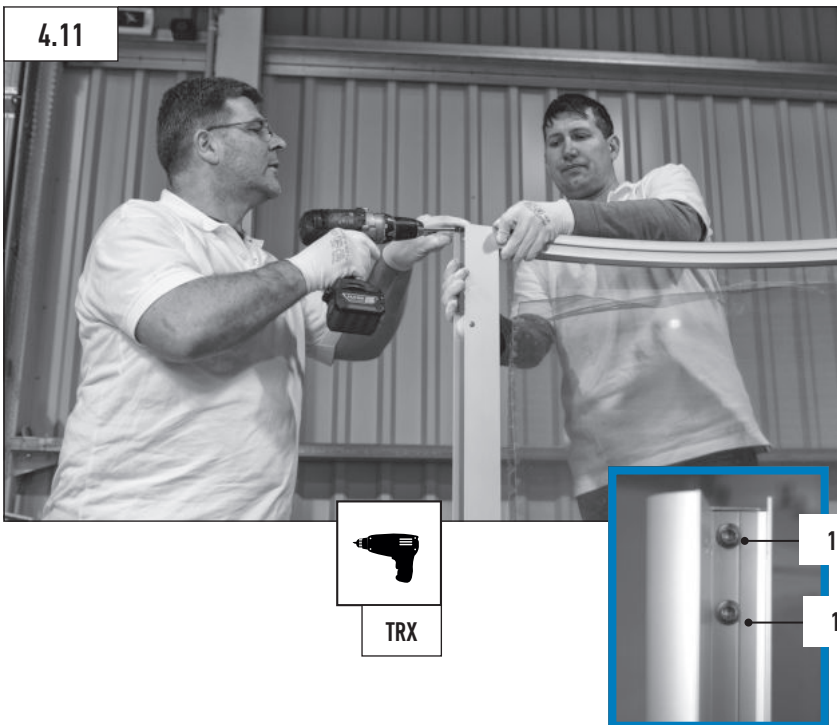

# 4 MONTERING ÖVRIGA SEKTIONER

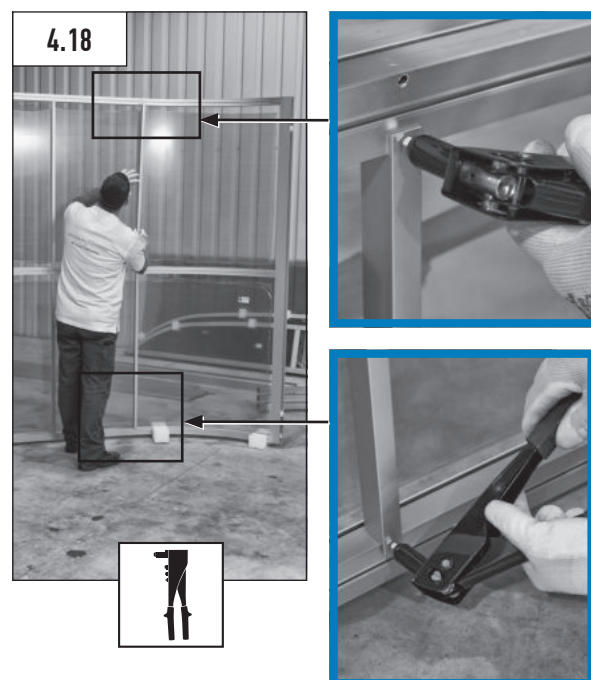
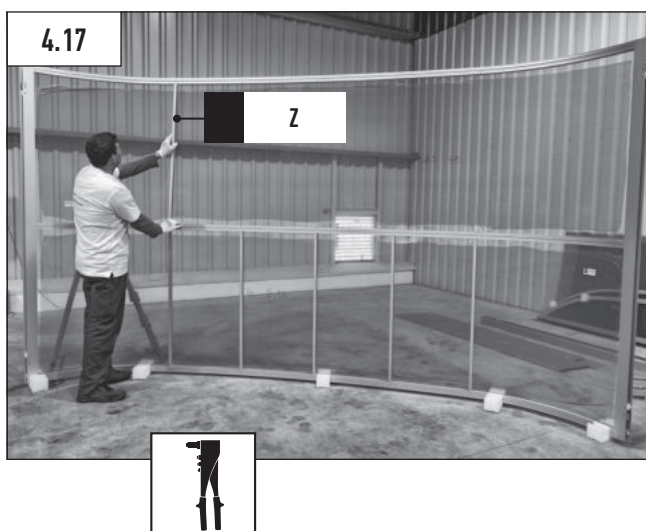
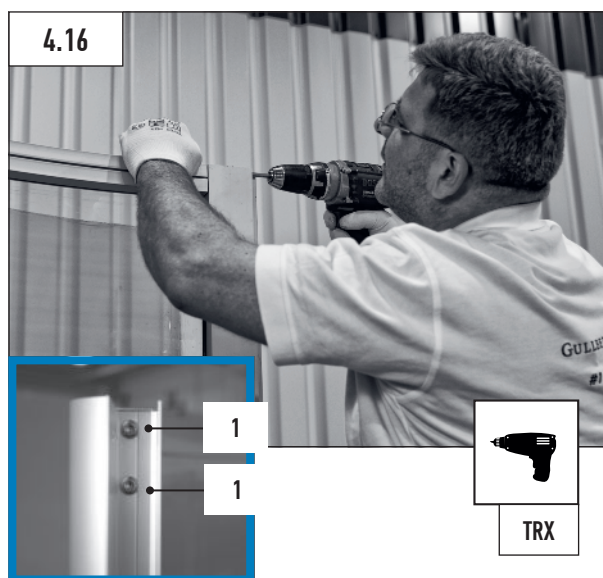
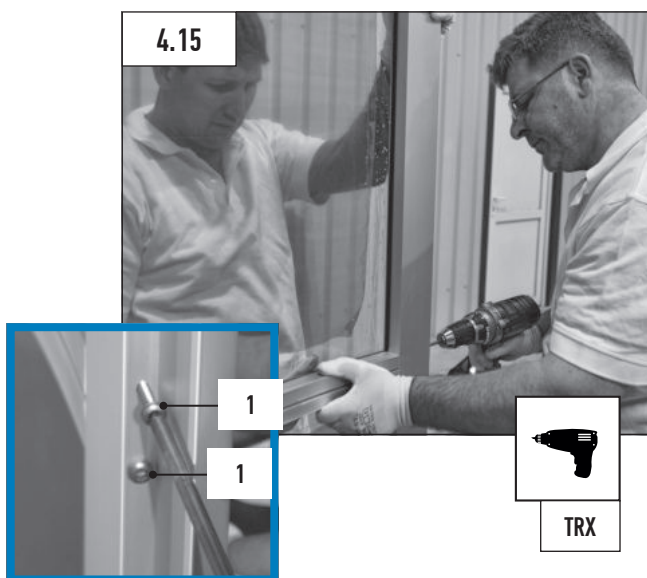
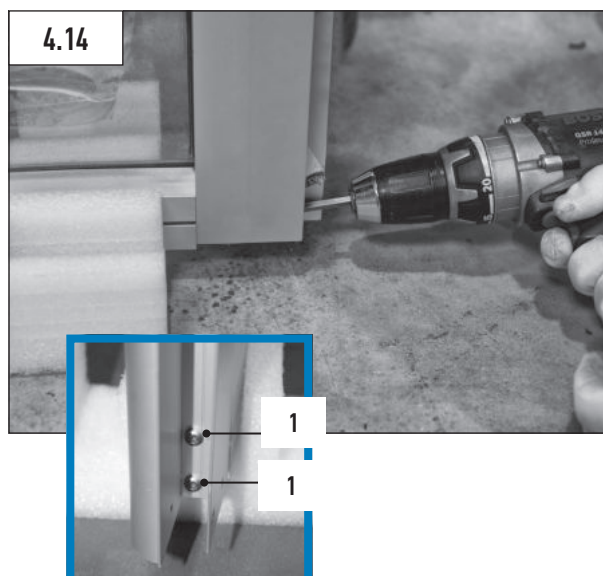
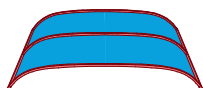

\*X = antal sektioner

## 4 MONTERING ÖVRIGA SEKTIONER

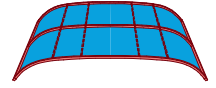

# 4 MONTERING ÖVRIGA SEKTIONER

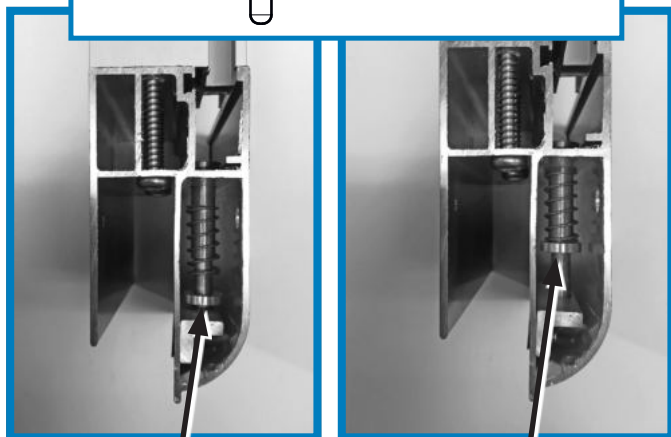
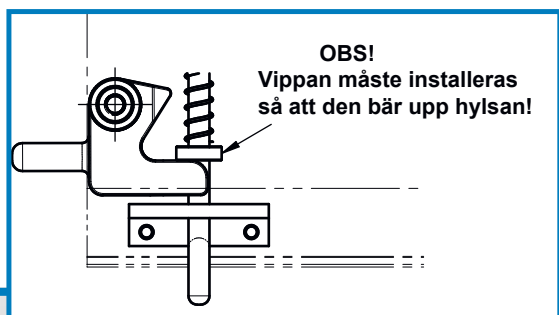
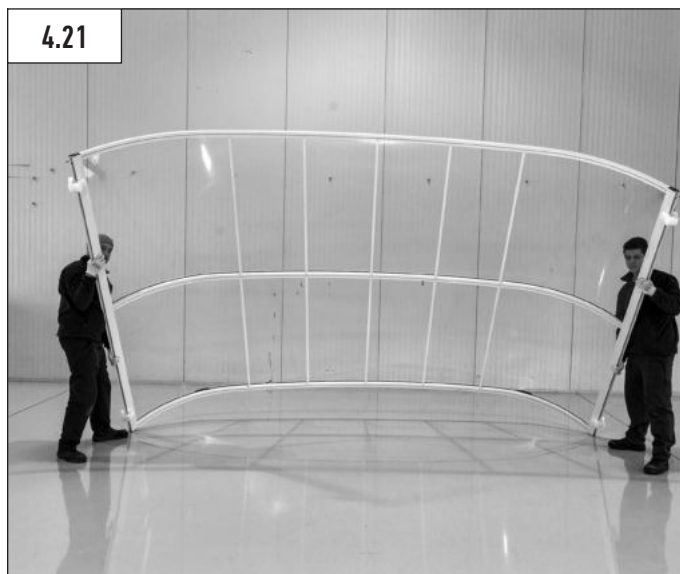
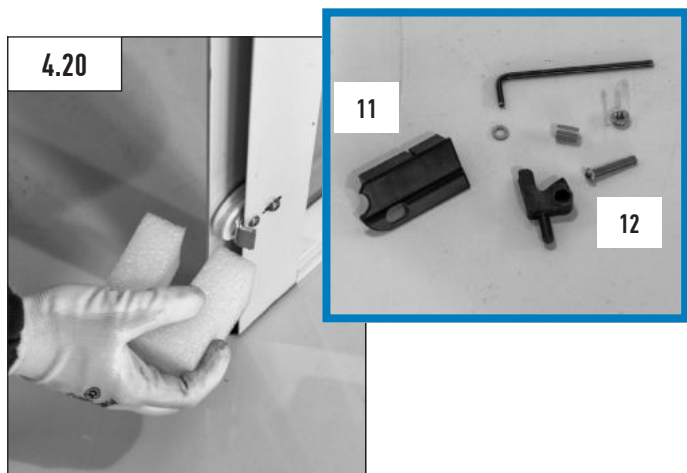

FEL

RÄTT

Säkerställ att brickan är i rätt position!

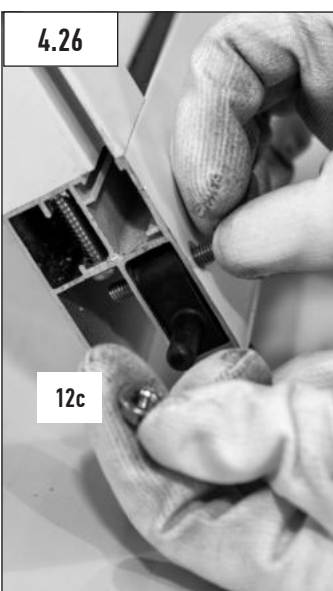
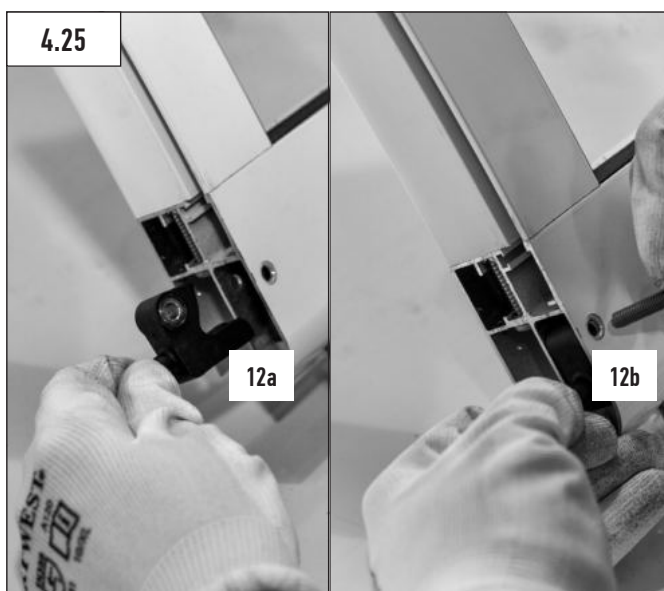

## 4 MONTERING ÖVRIGA SEKTIONER

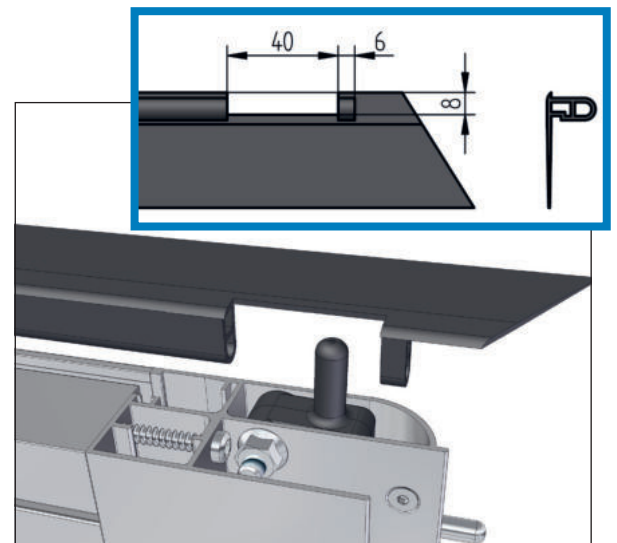
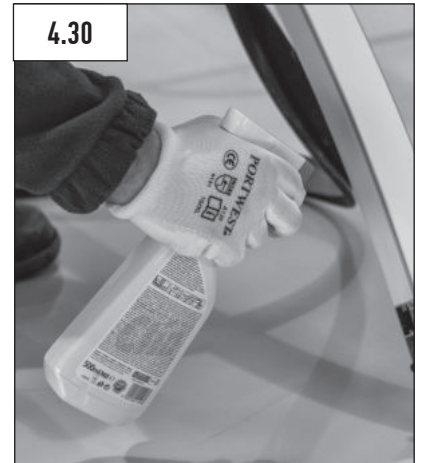
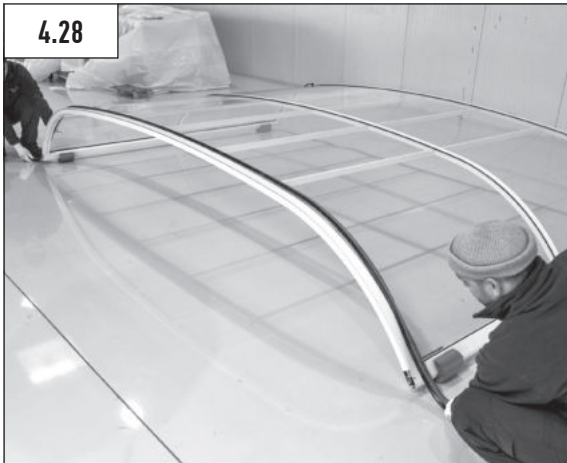

## 4 MONTERING ÖVRIGA SEKTIONER

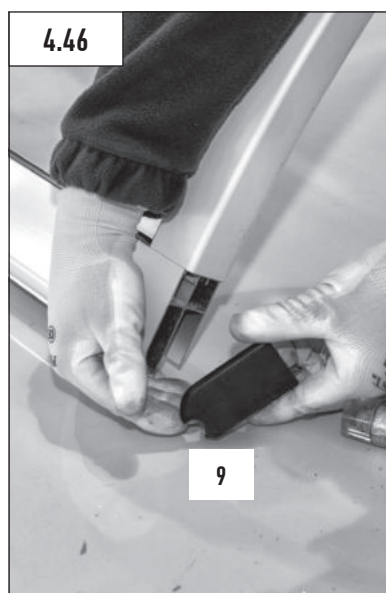
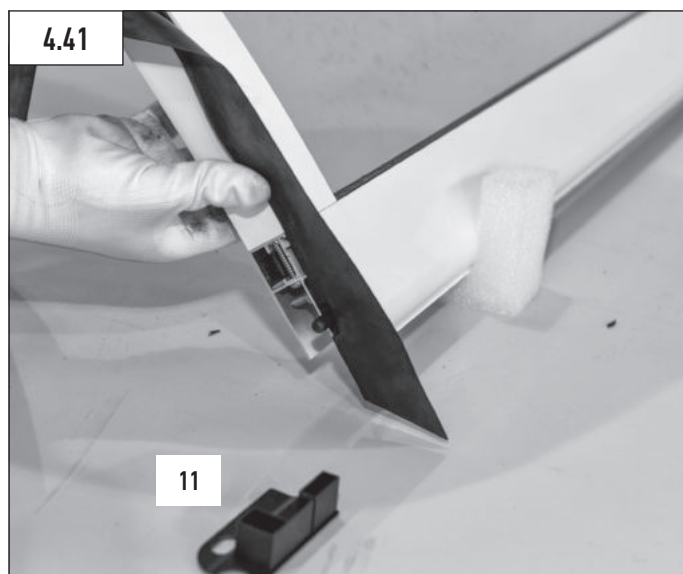

UPPREPA STEG 4.1 - 4.47  
(SE SIDORNA 18-24)



# 5 MONTERING GUMMILISTER - ENDAST FÖR PL KLAR PANELER



## 5 MONTERING GUMMILISTER - ENDAST FÖR PL KLAR PANELER



## 5 MONTERING GUMMILISTER - ENDAST FÖR PL KLAR PANELER

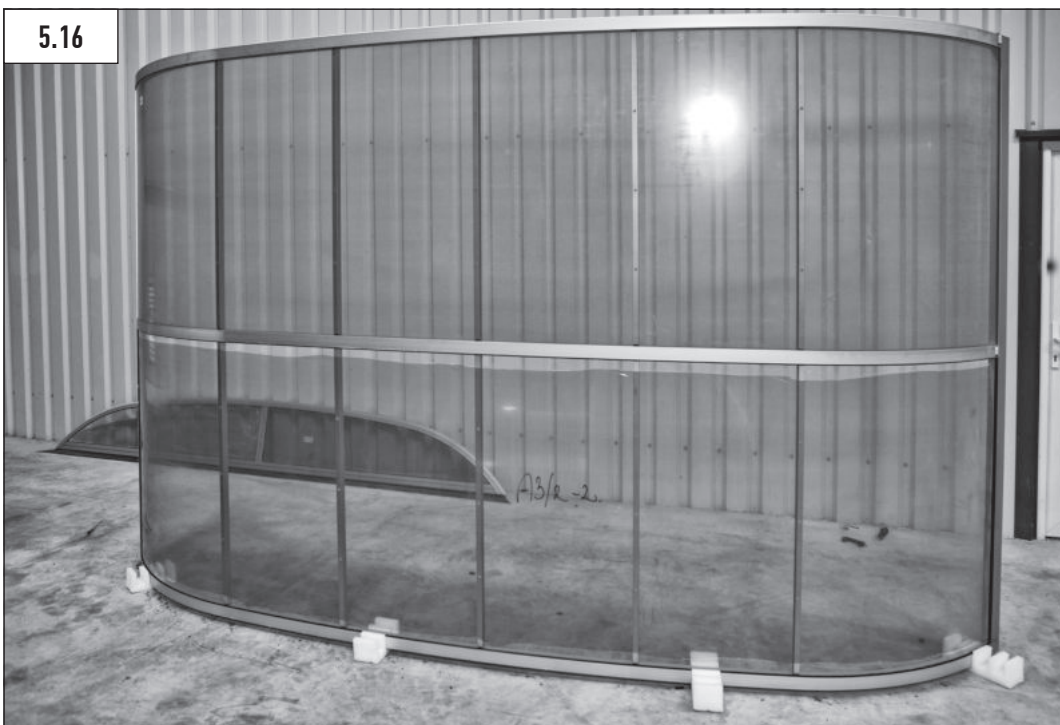

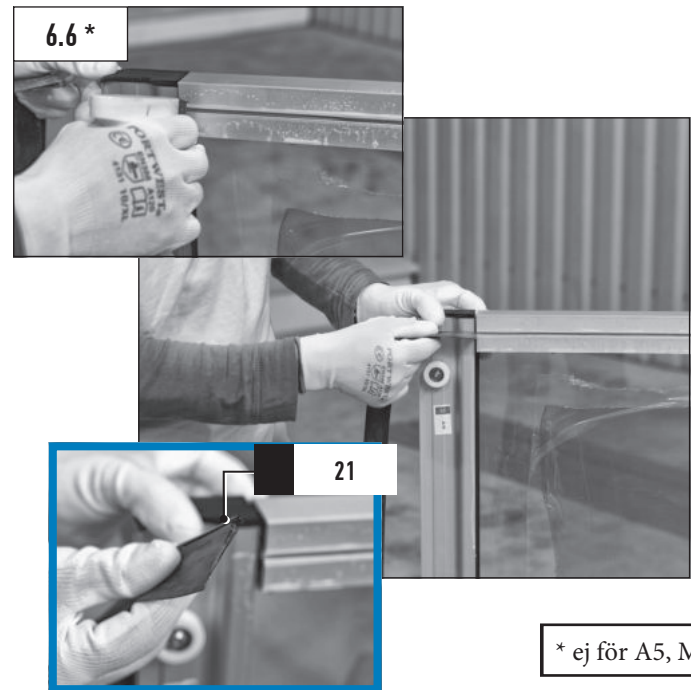
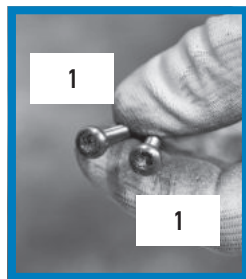
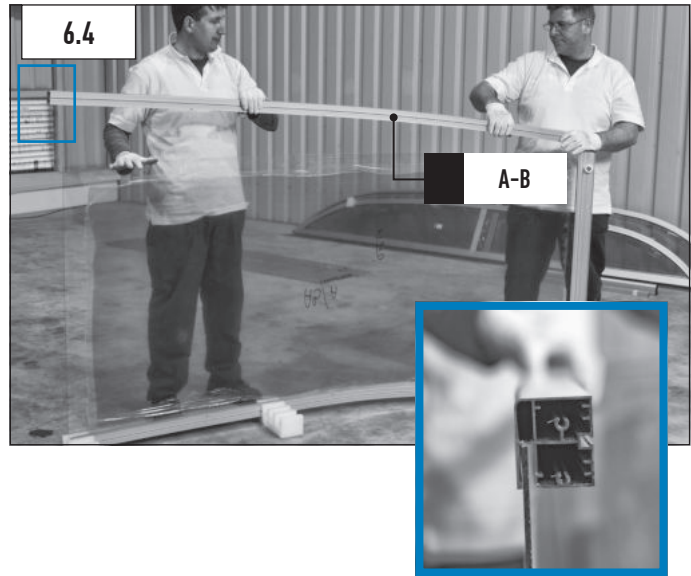
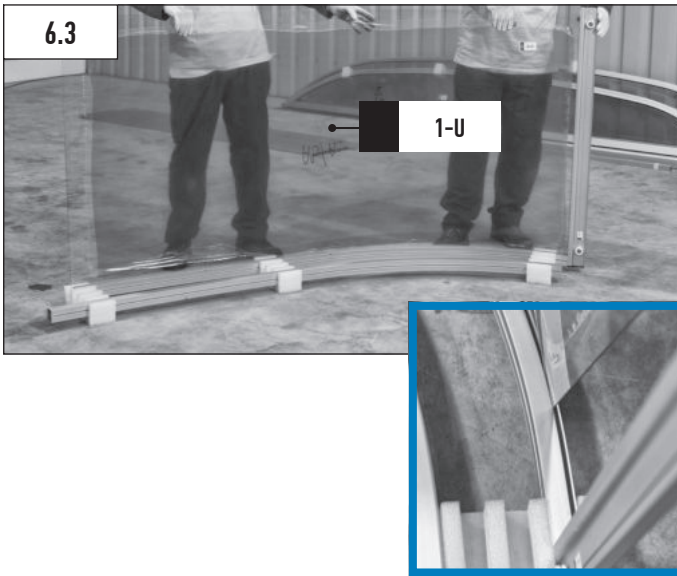
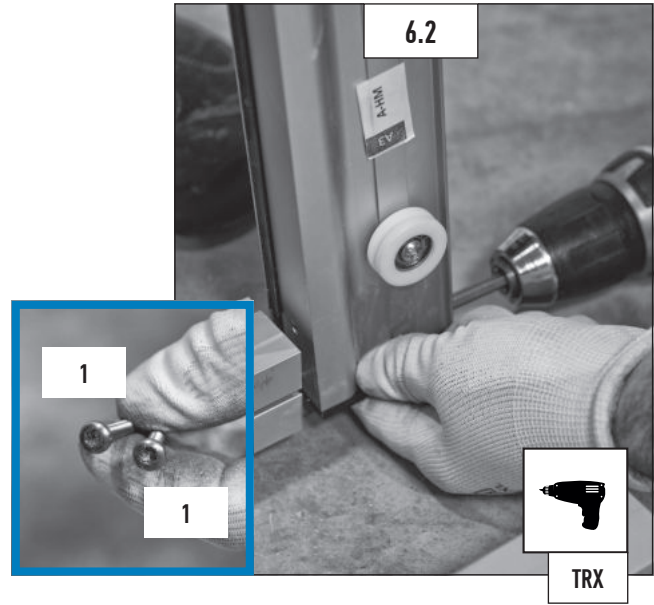
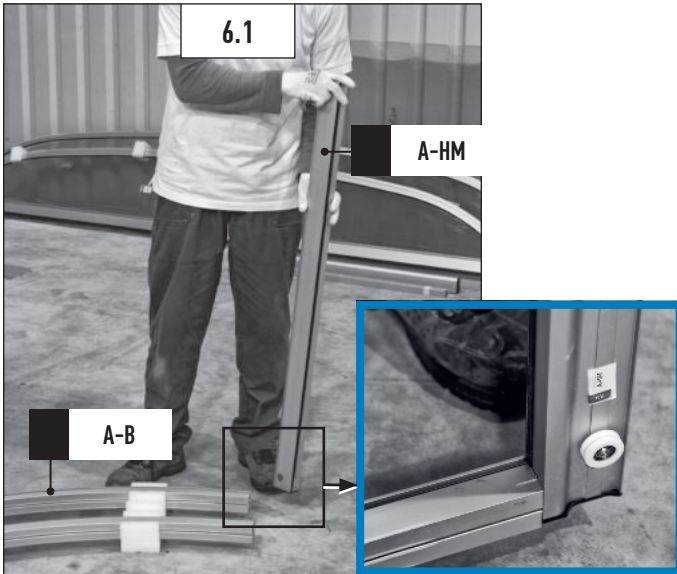

\* ej för A5, M5

# 6 MONTERING SKJUTDÖRR



6.7\*

\*EXCL. A5, M5



6.8

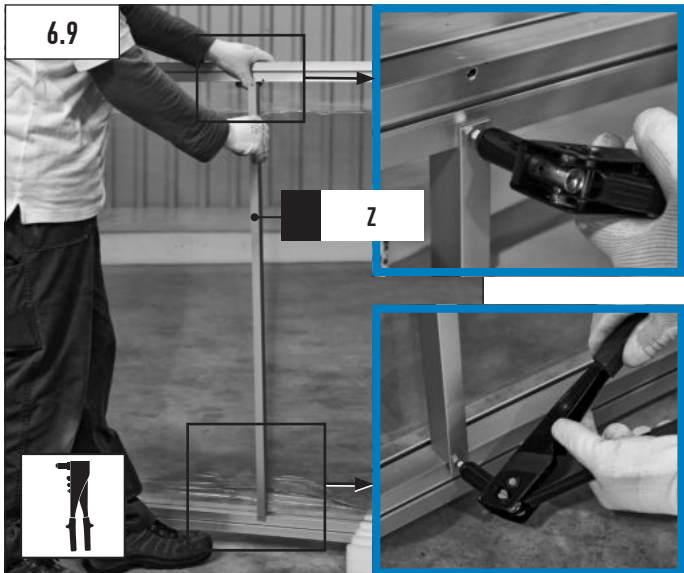
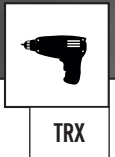

6.9

Z



6.10

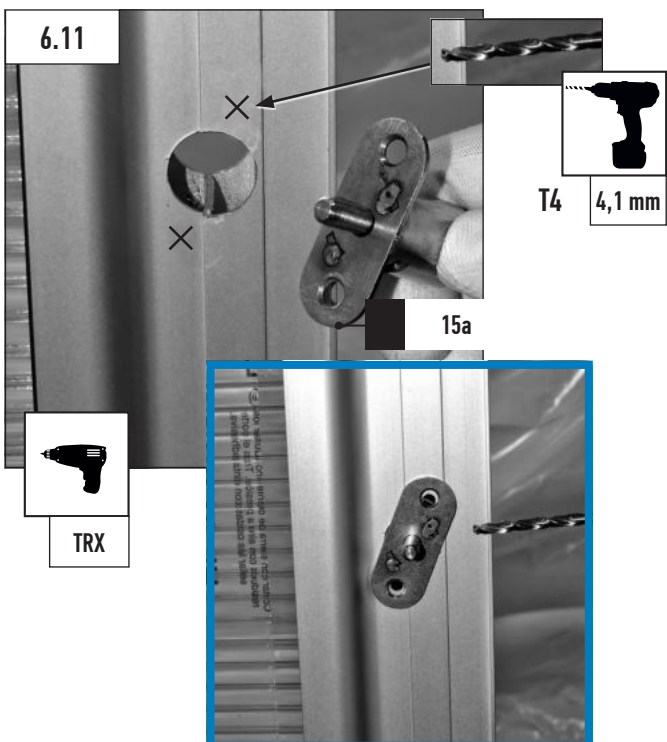

6.11

T4 4,1 mm

15a

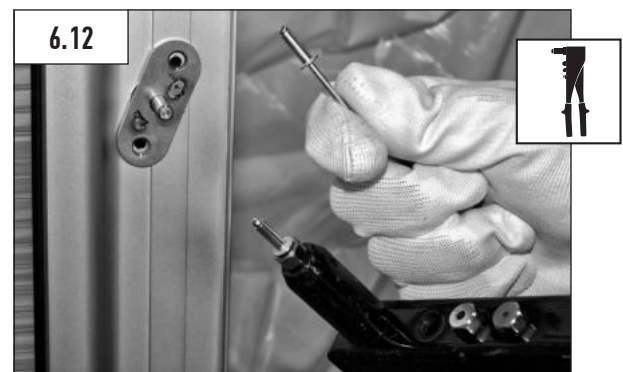

6.12



# 6 MONTERING SKJUTDÖRR

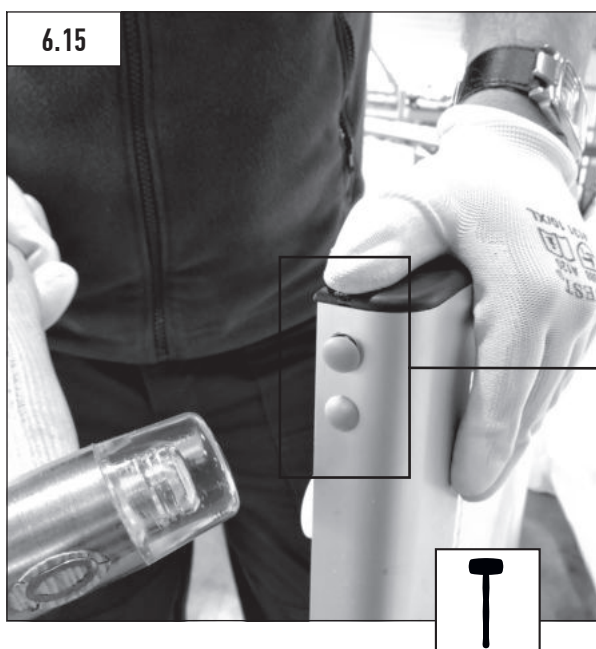
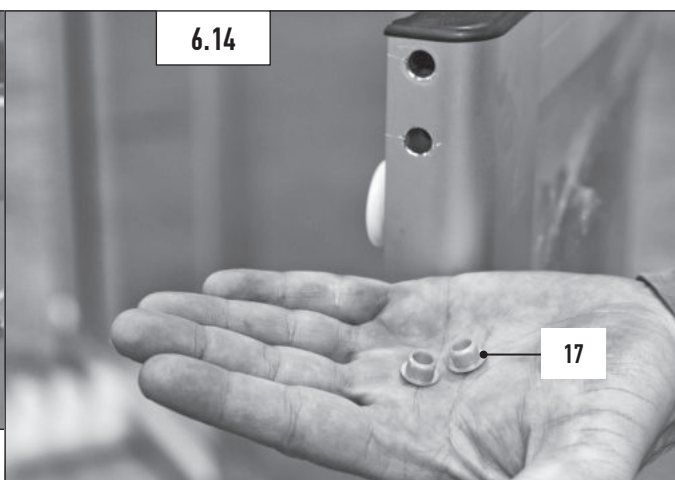

## 6 MONTERING GUMMILISTER SKJUTDÖRR ENDAST FÖR PC KLAR PANELER

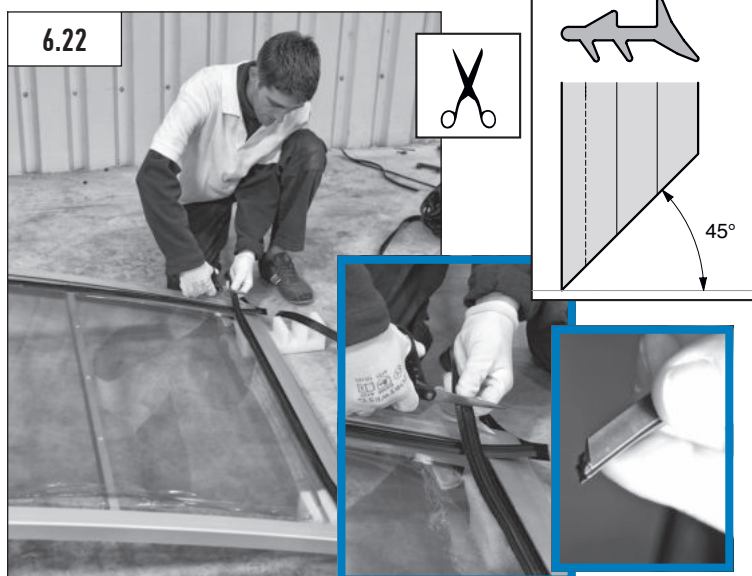
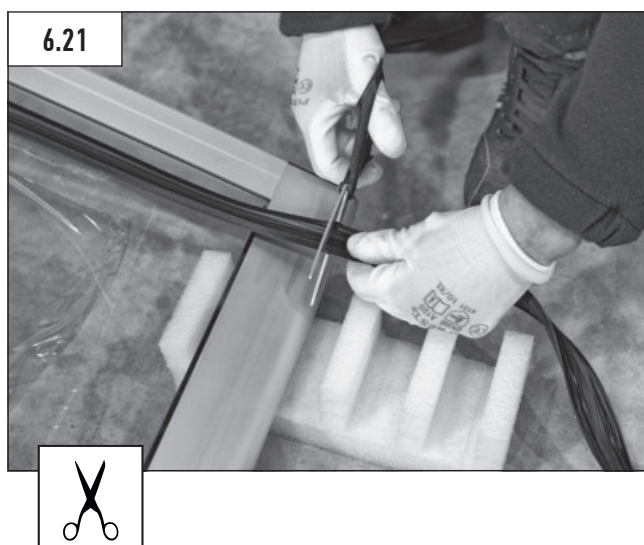
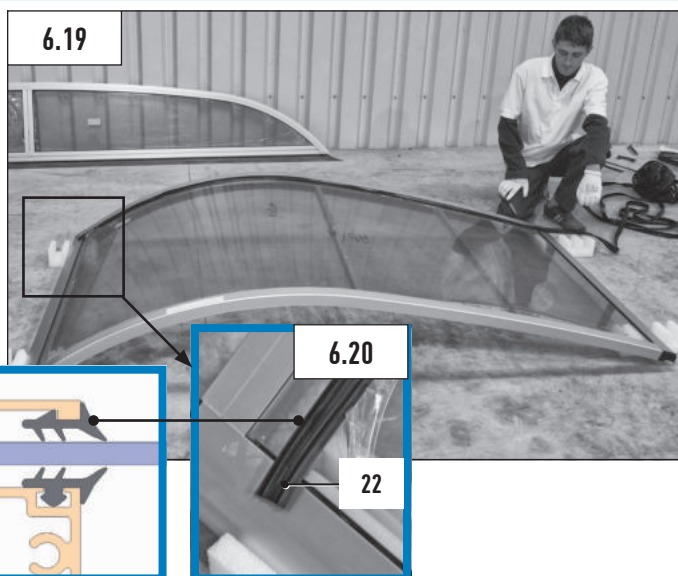
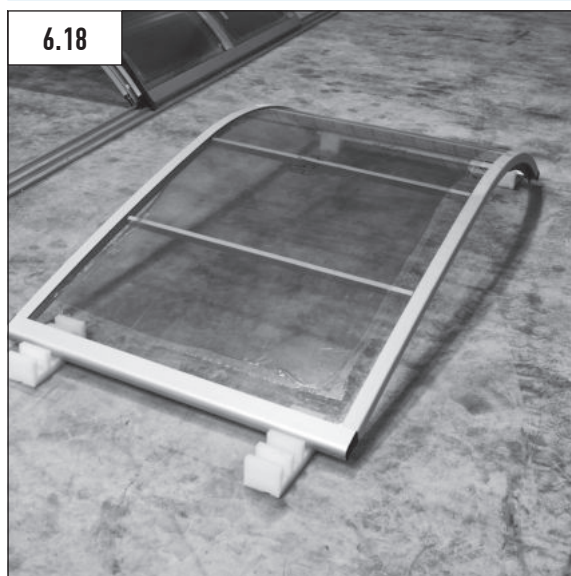

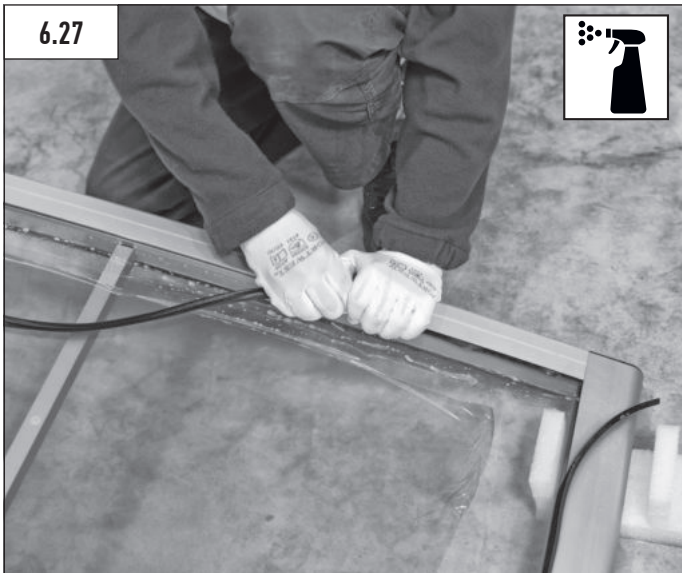
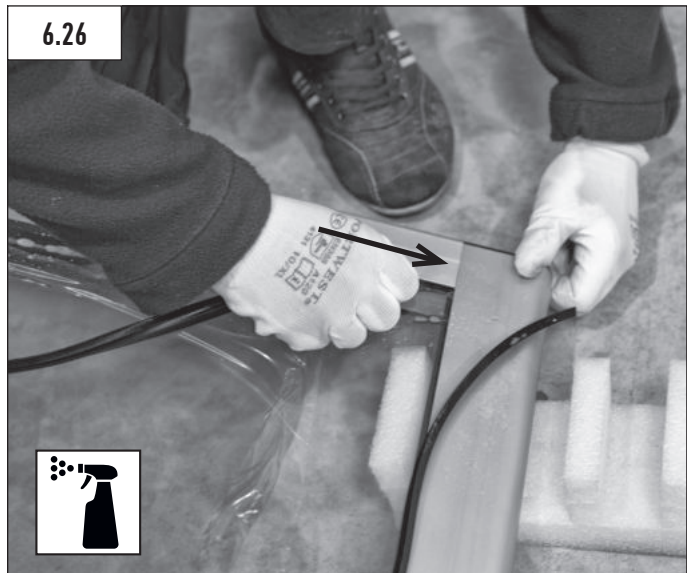
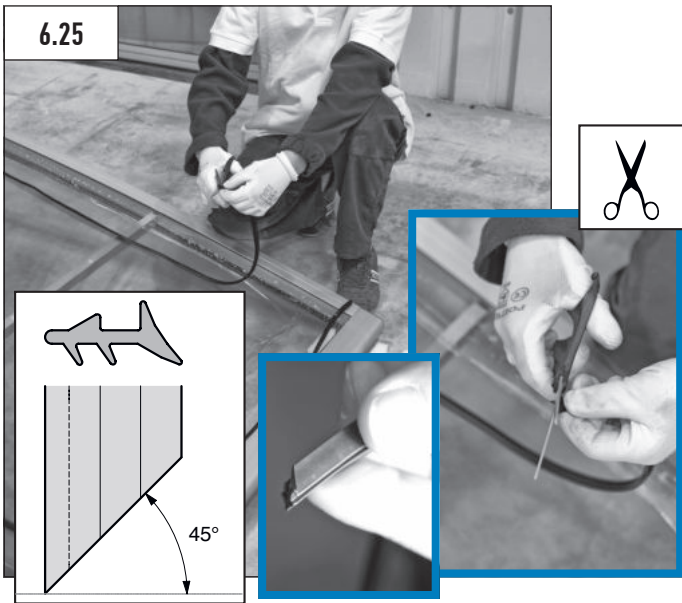



## 6 MONTERING GUMMILISTER SKJUTDÖRR ENDAST FÖR PC KLAR PANELER

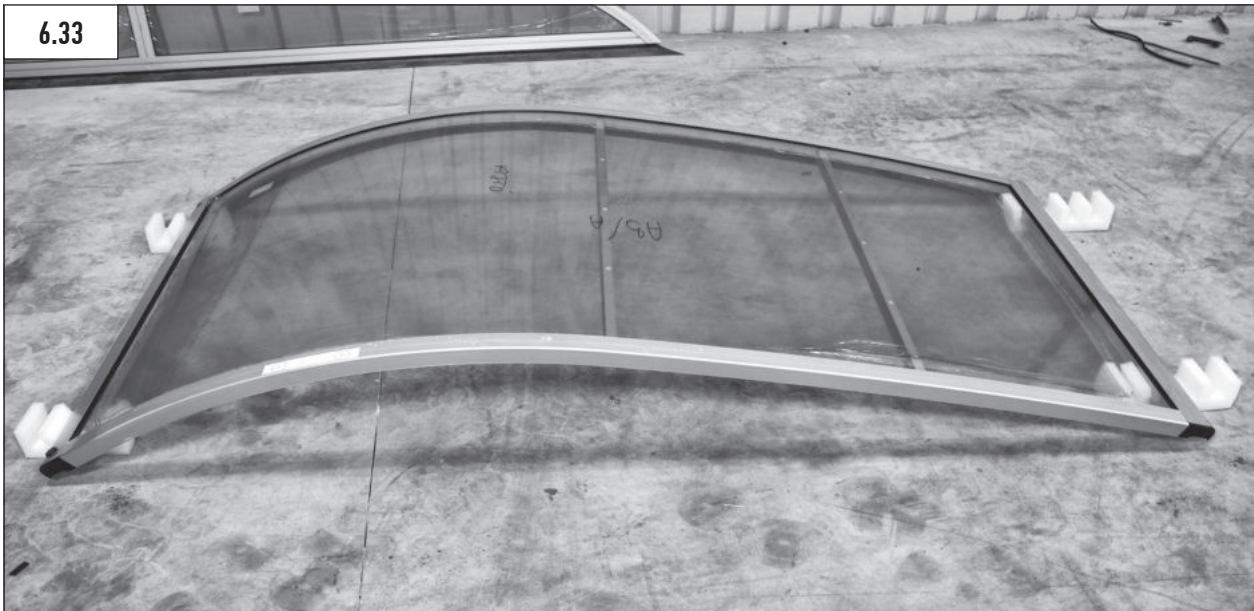
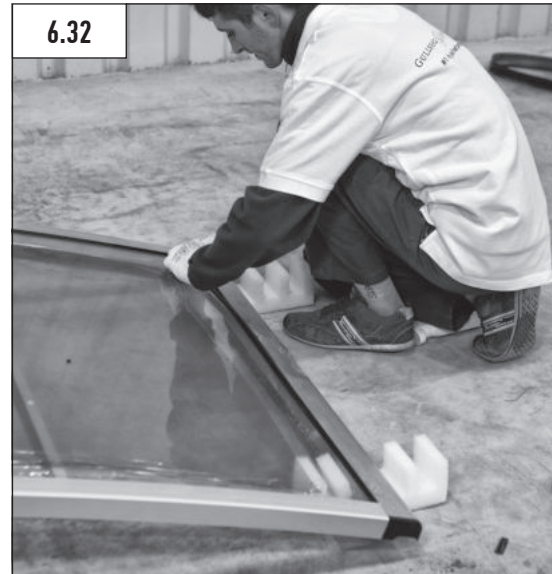

# 7

## MONTERING AV SEKTIONERNA PÅ SKENA

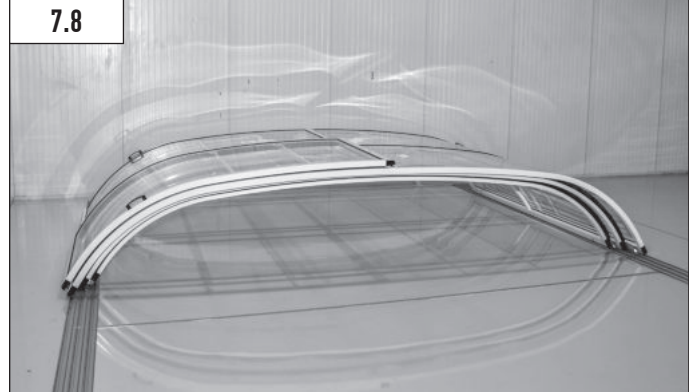
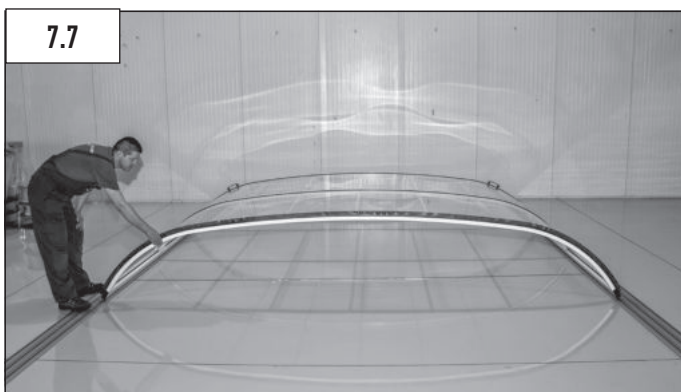
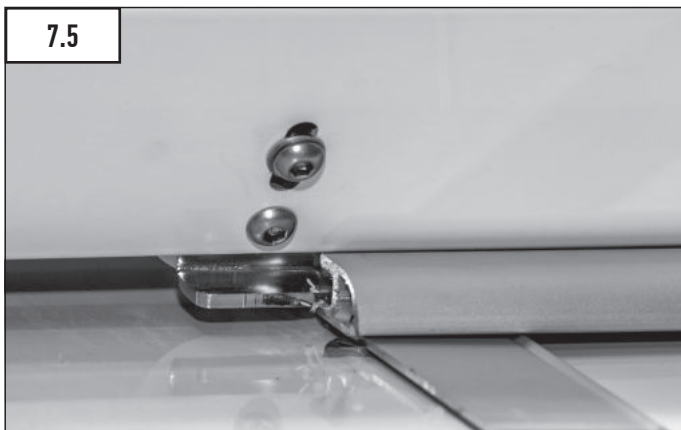
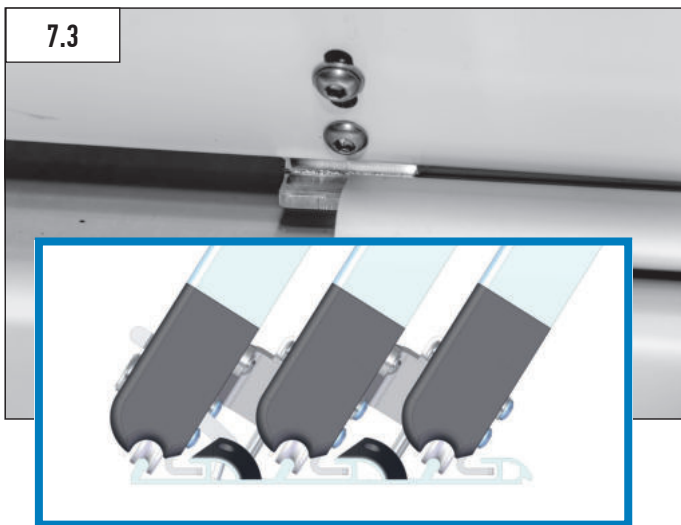
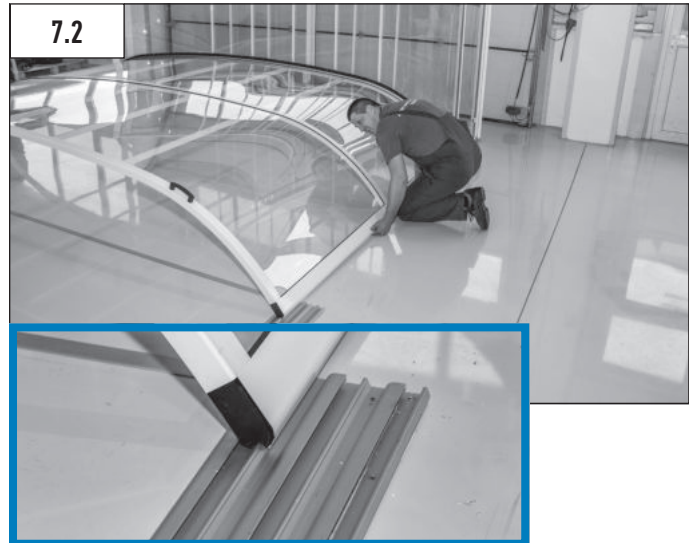

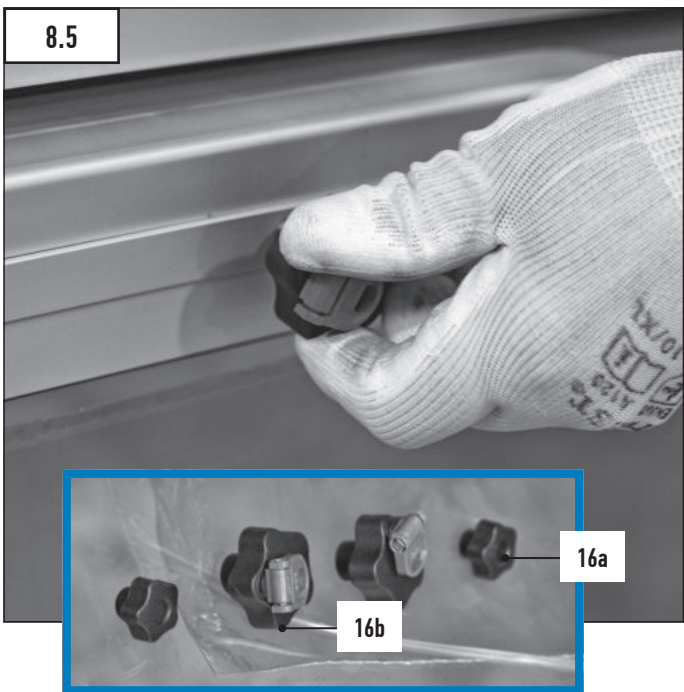
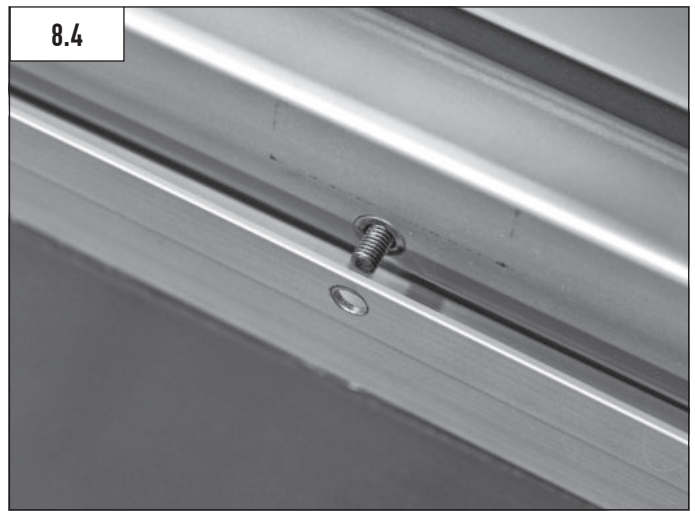

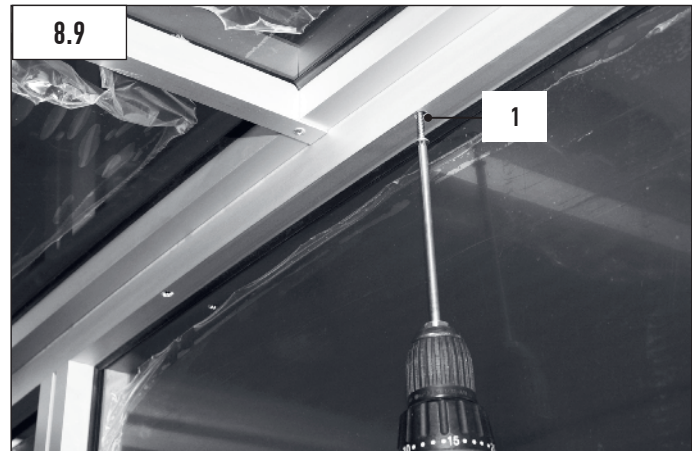
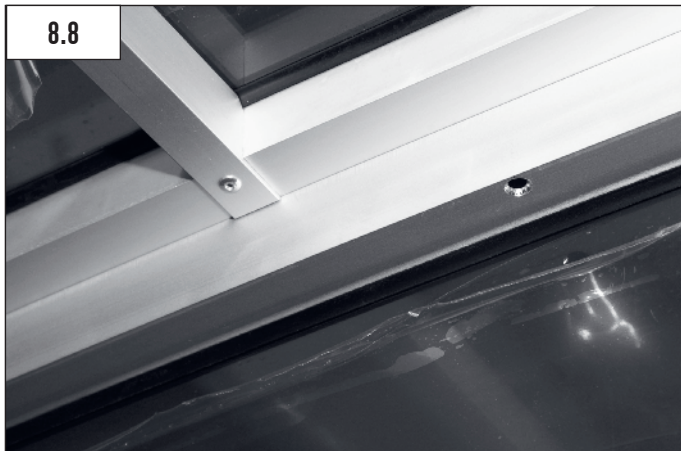

för A5-M5 modeller

Börja med att fästa gavlarna  
mot bågprofilerna från mitten  
och ut!

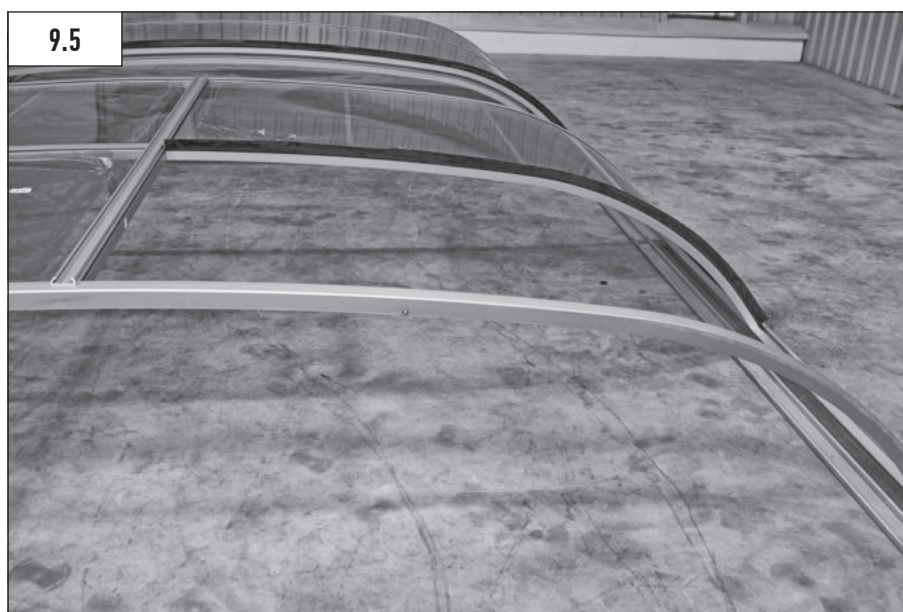
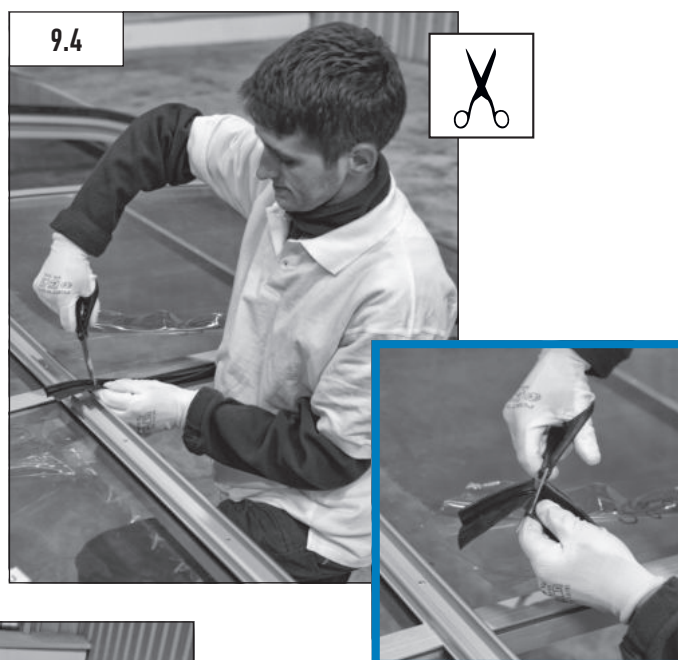
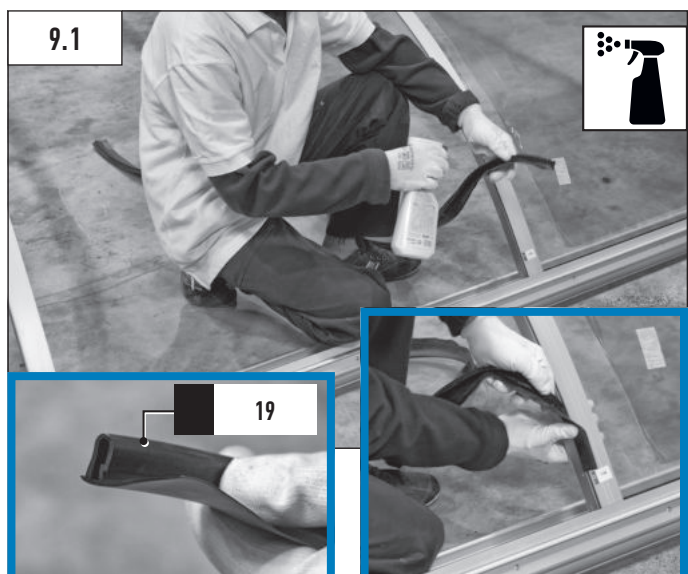

endast A3 - A3/4 - A4S - A4L - A4 - A4/5 - M3 - M4 - M4/5 modeller

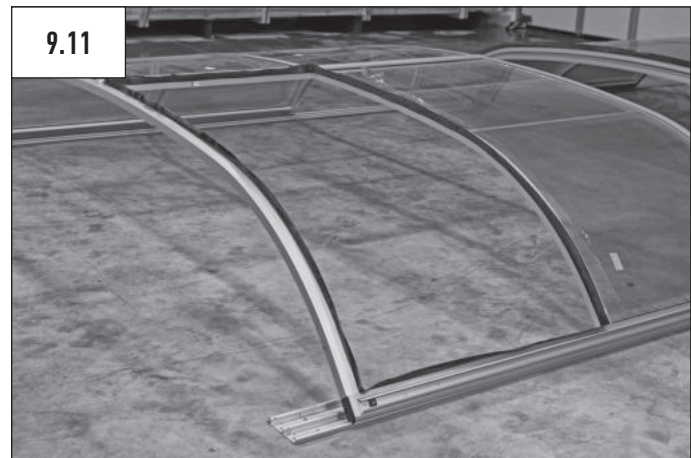
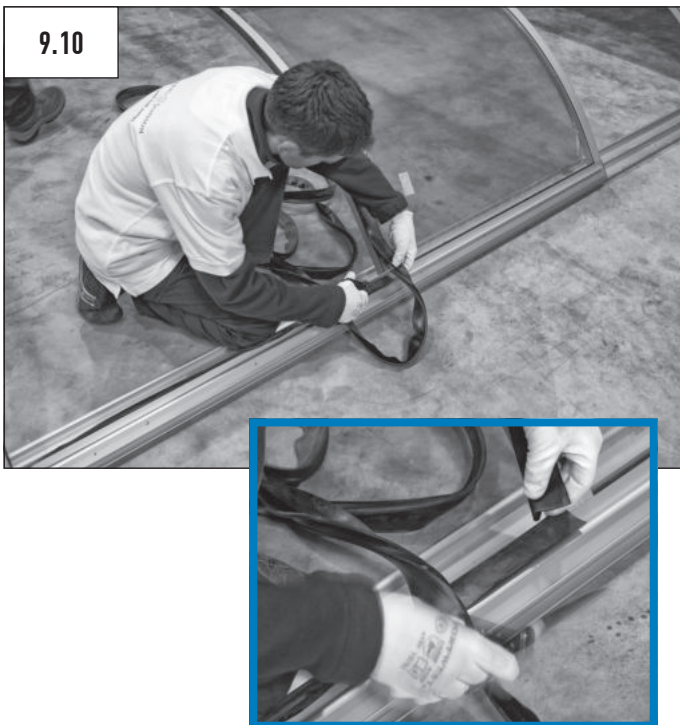
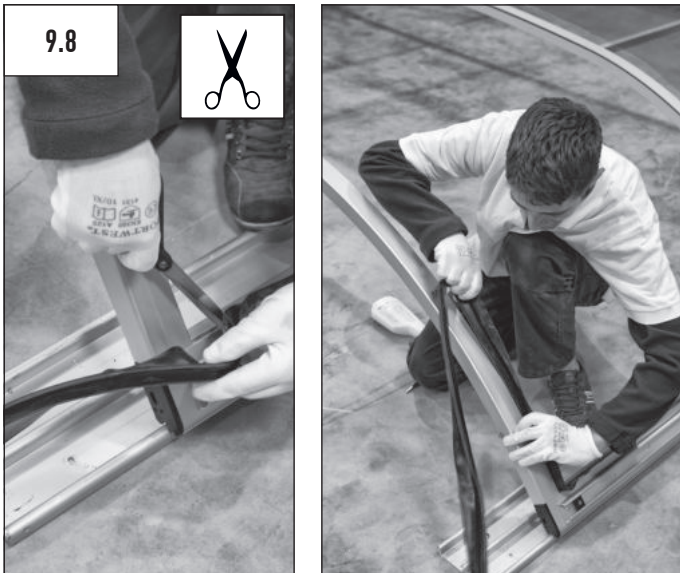
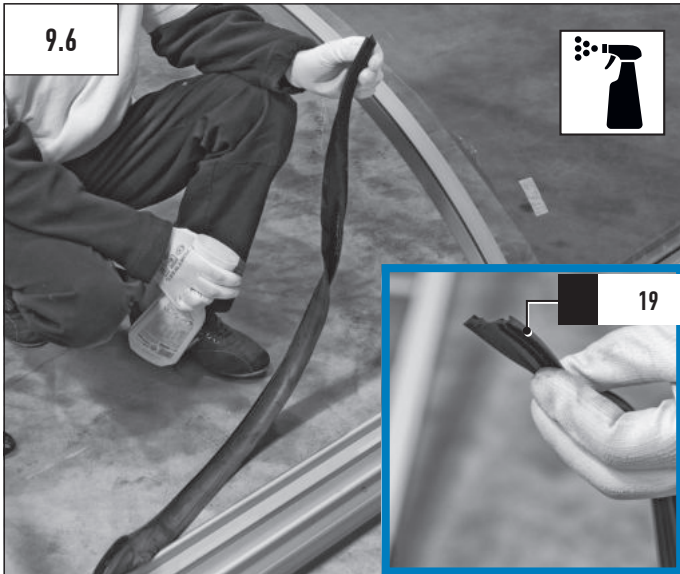

endast A5 - M5 modeller

# 9 MONTERING SKJUTDÖRR

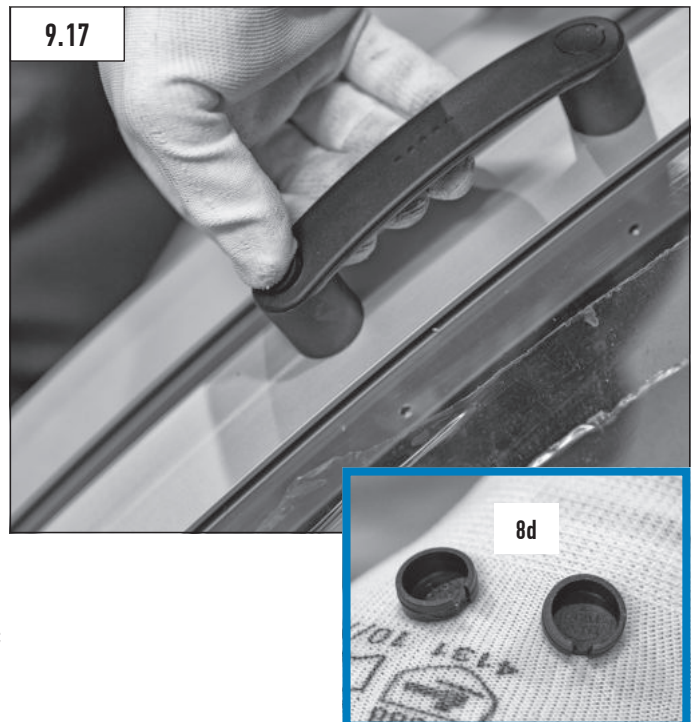
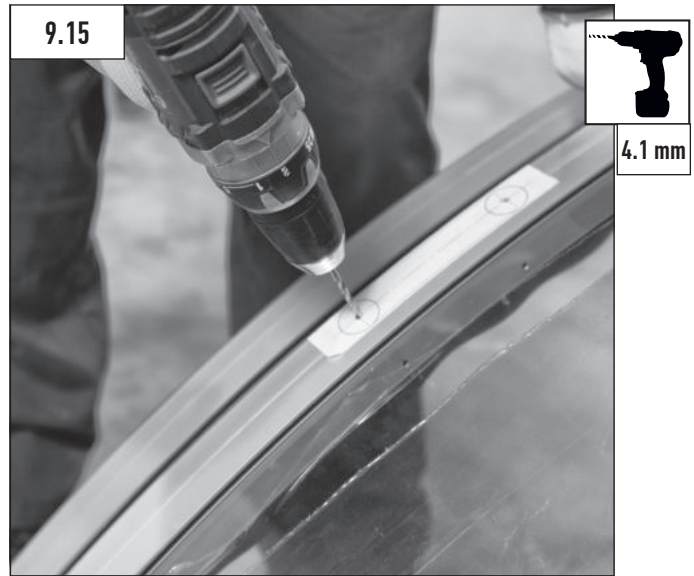
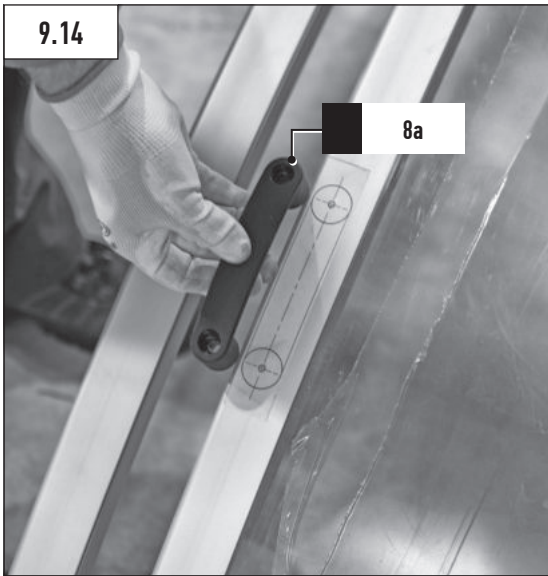
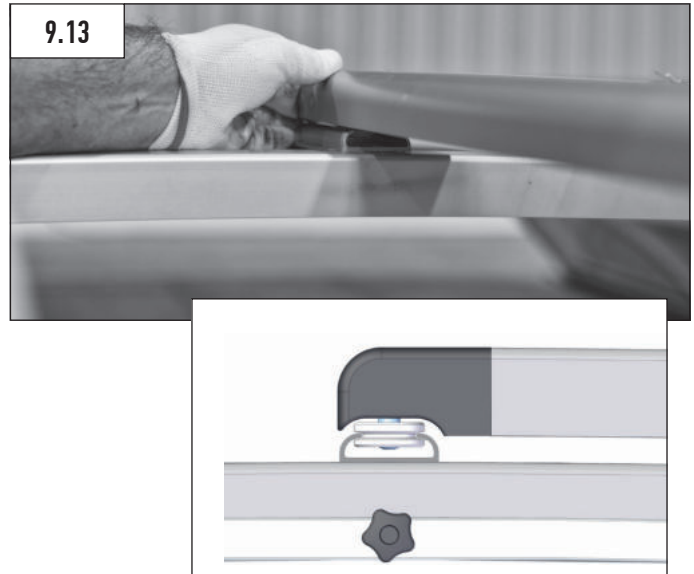

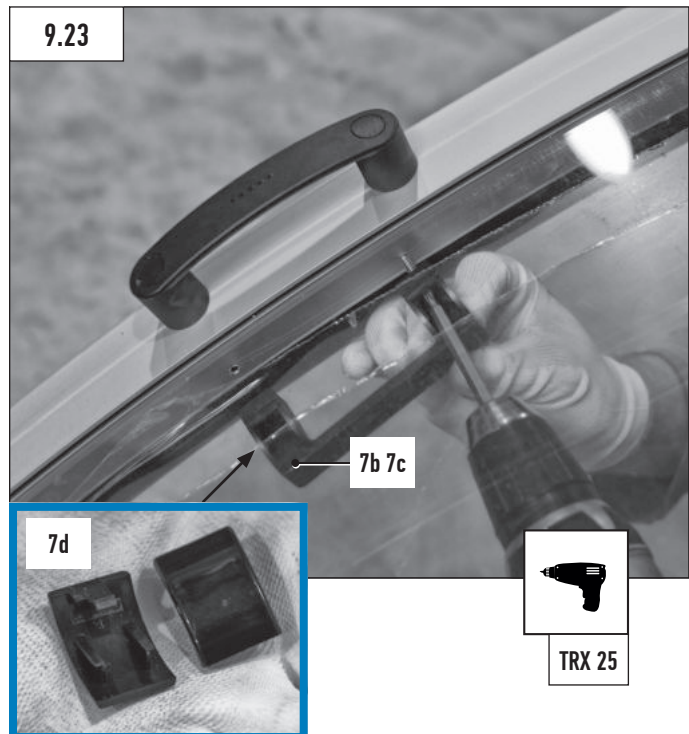
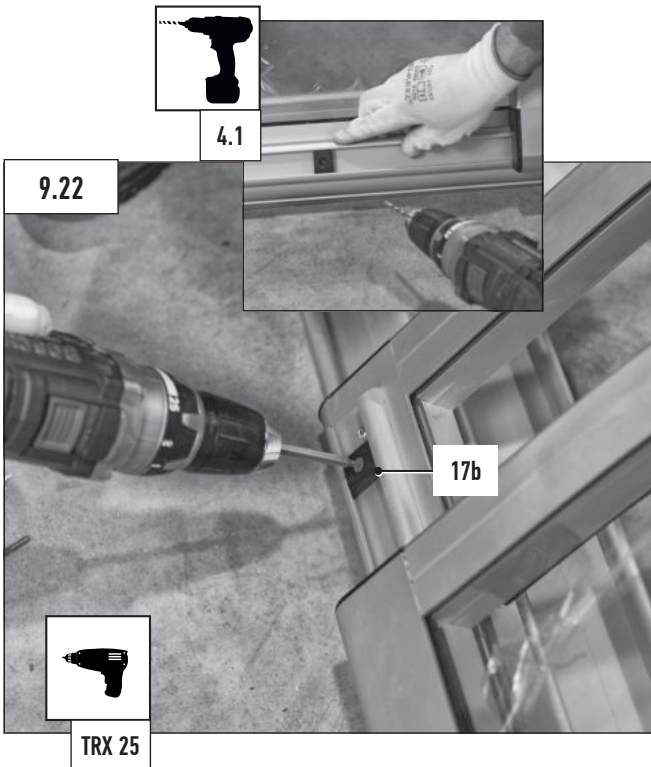
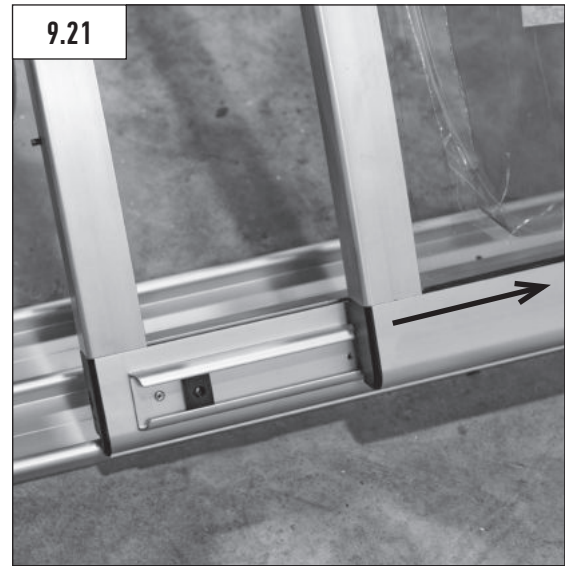
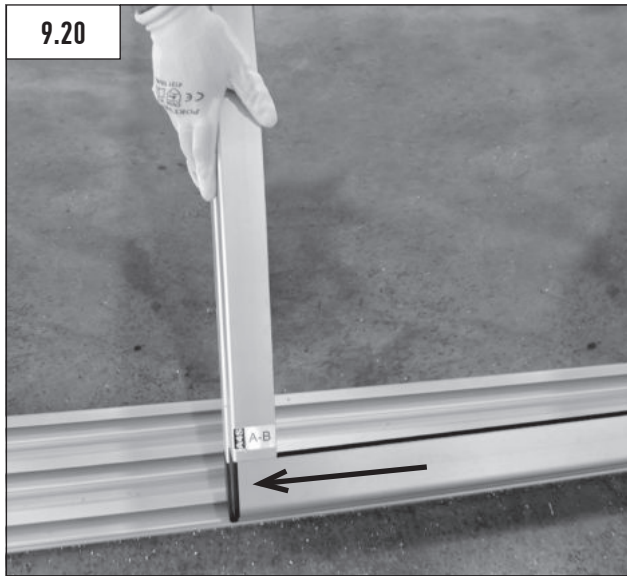
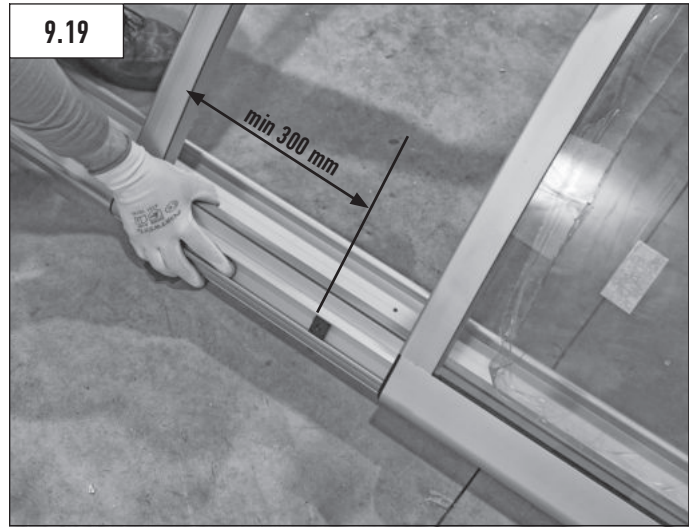
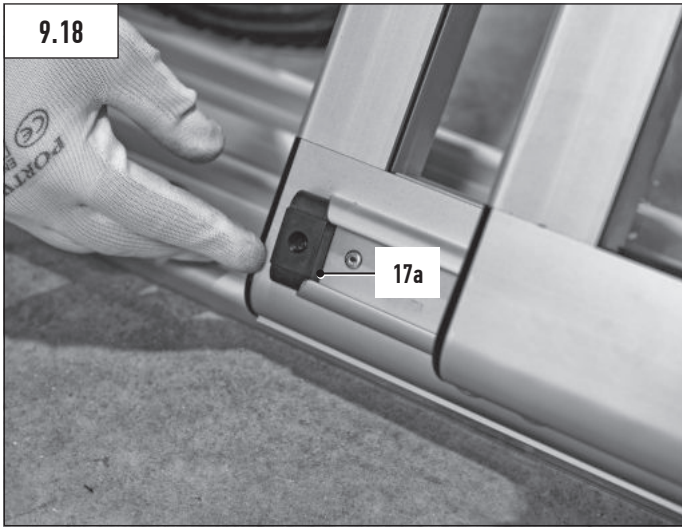



# 9 MONTERING SKJUTDÖRR

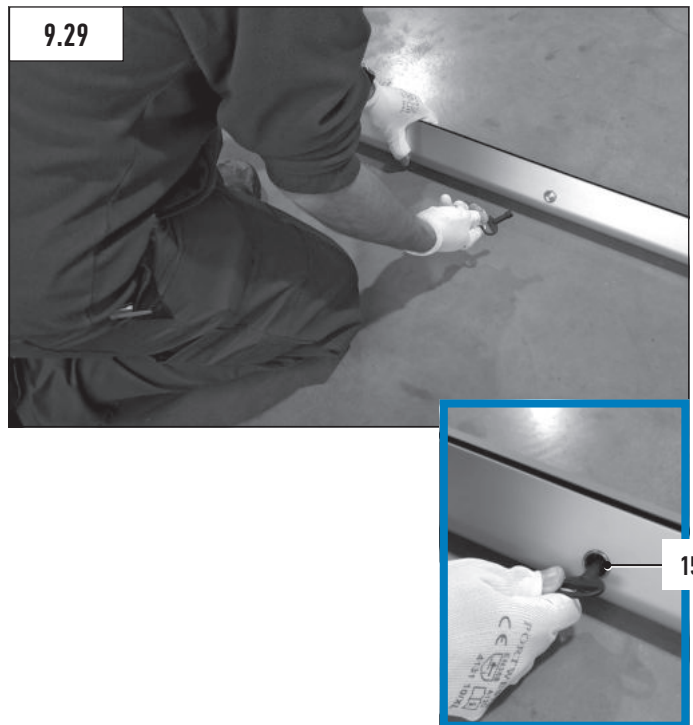
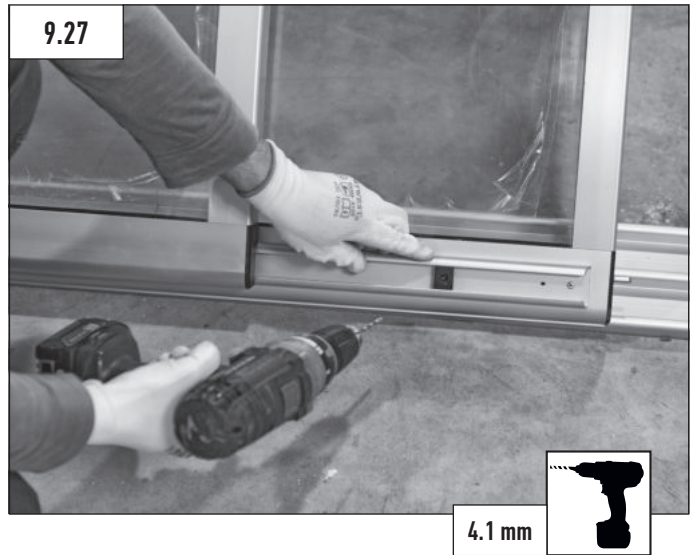
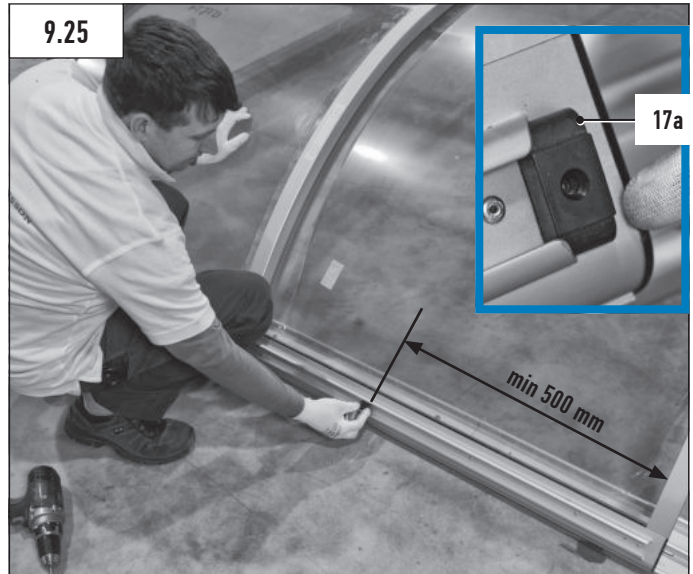

# 10 SLUTMONTERING

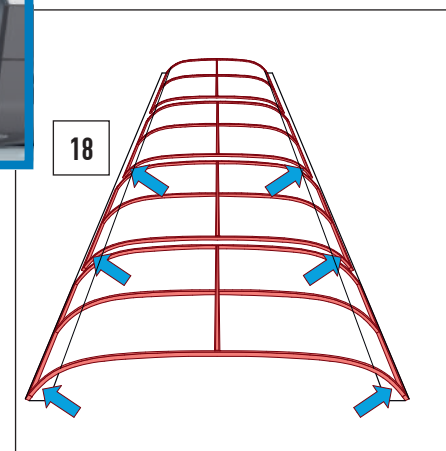
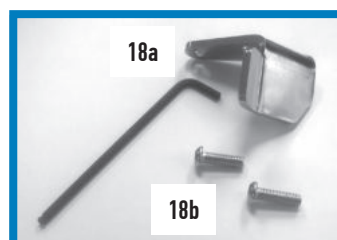
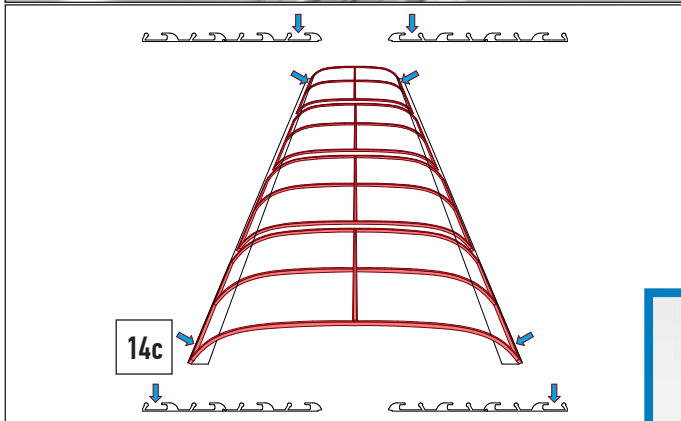
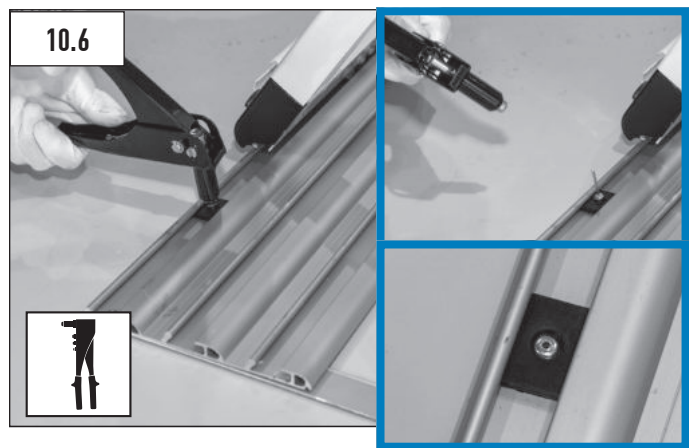
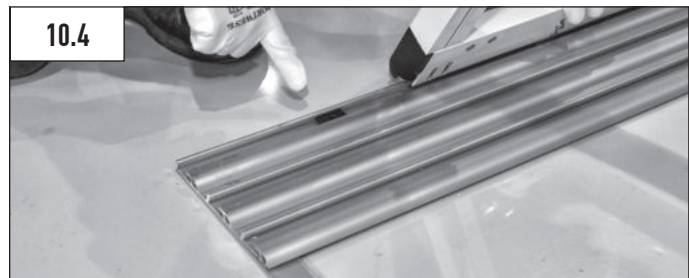
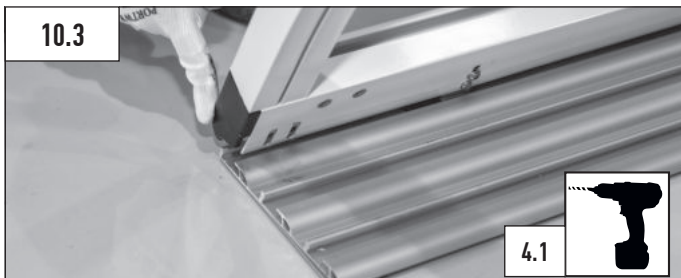
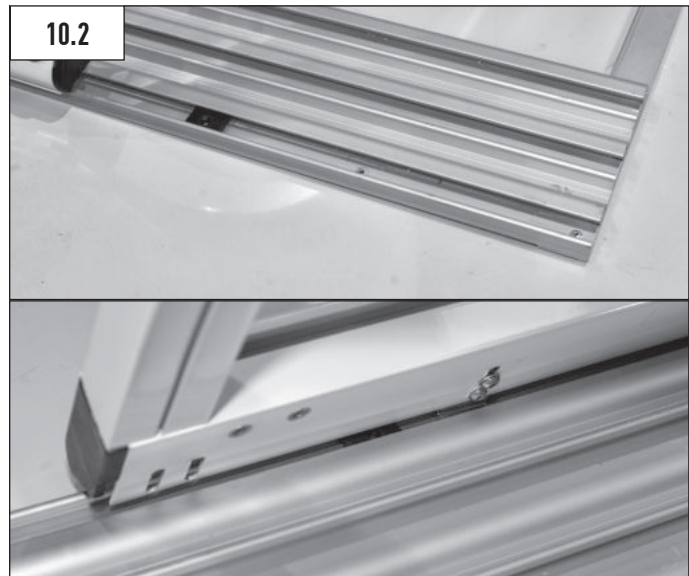
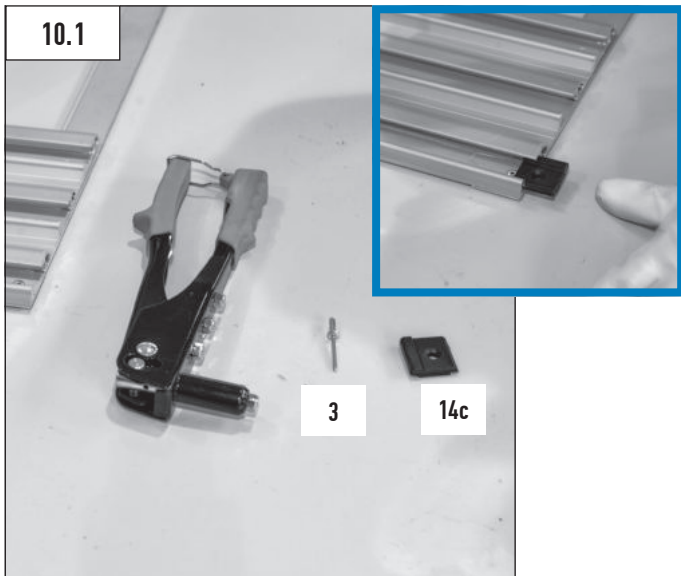

← mot framsidan

→ mot baksidan

# 10 SLUTMONTERING

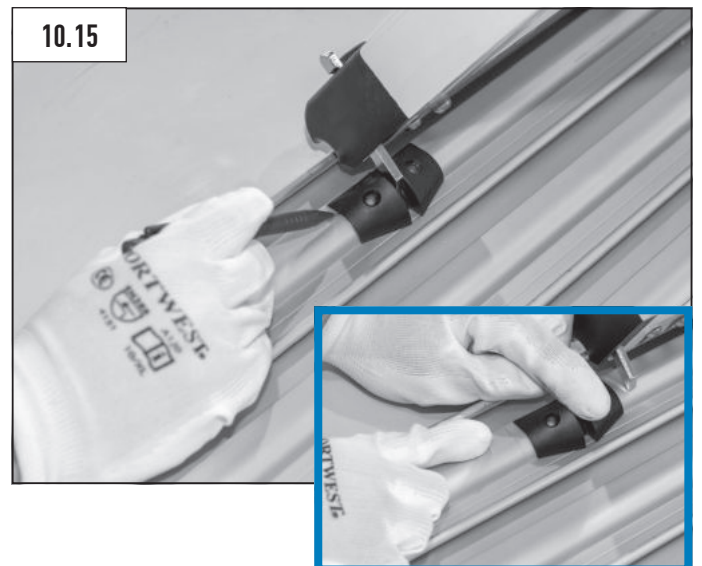
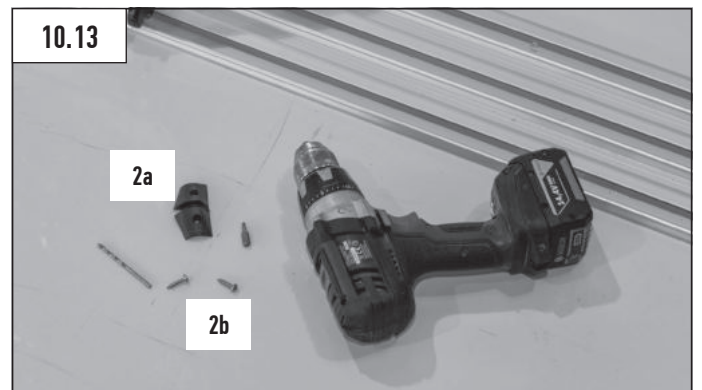
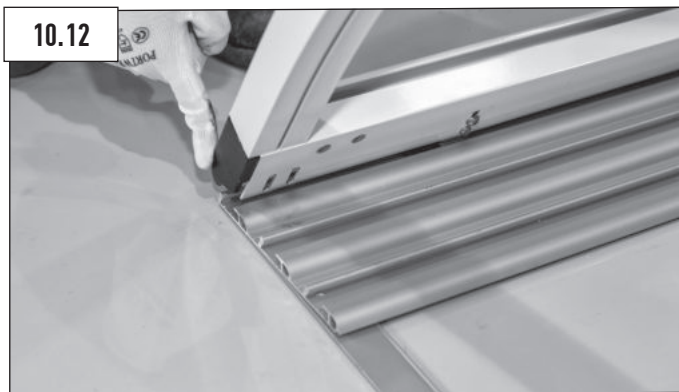
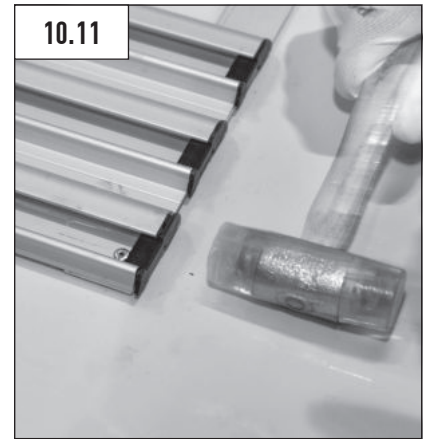
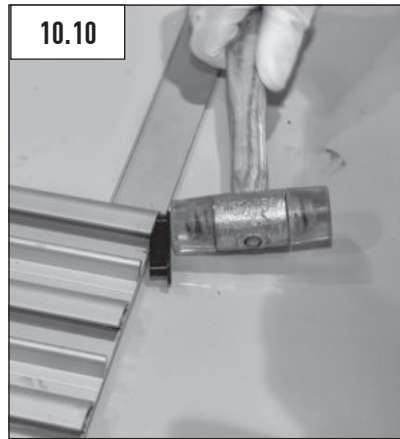
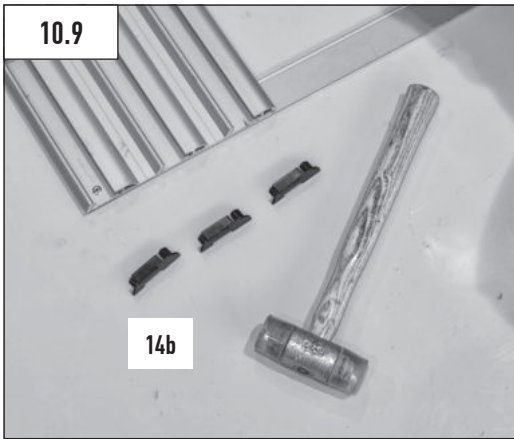
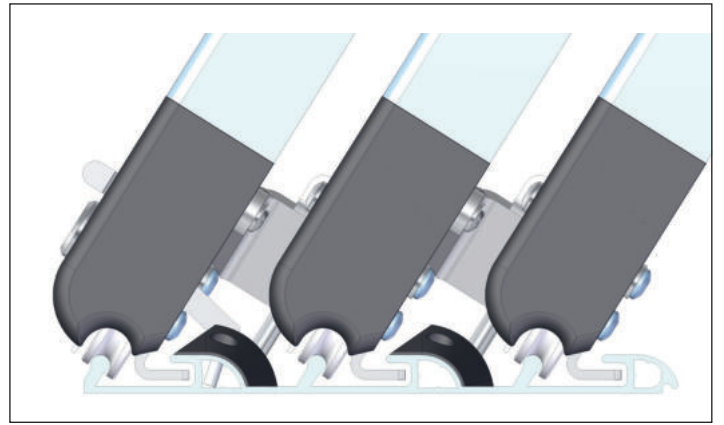

# 10 SLUTMONTERING

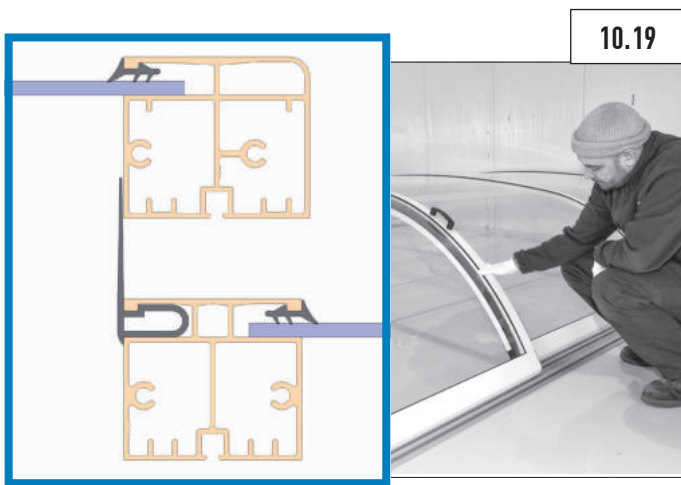
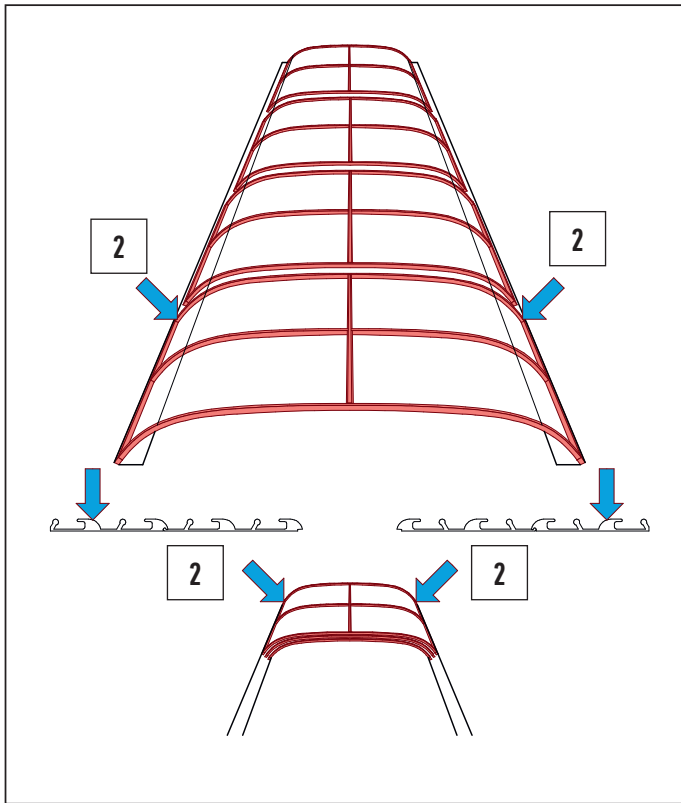
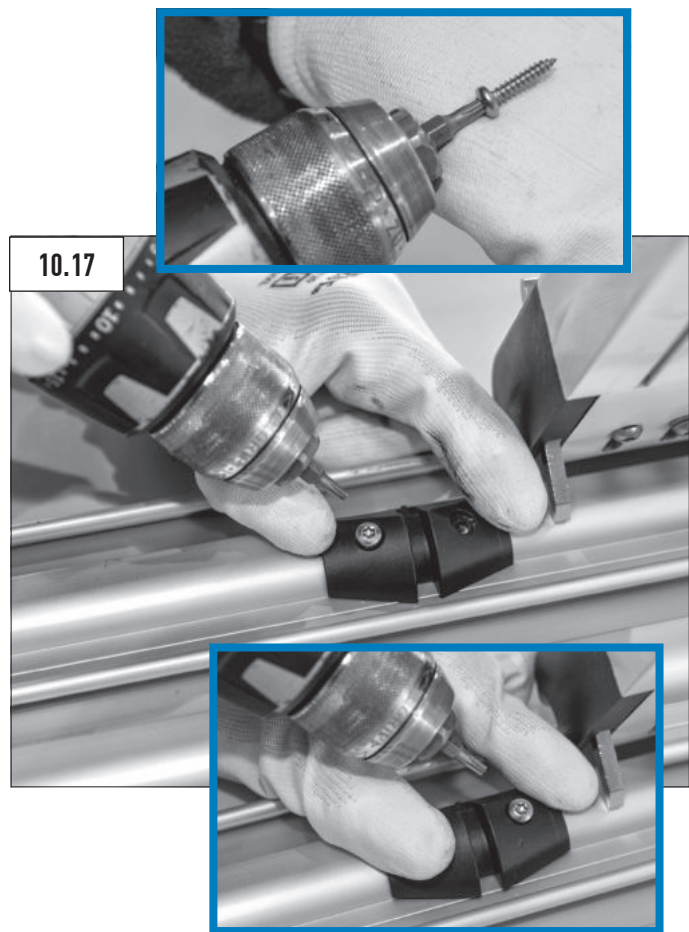

# 10 SLUTMONTERING

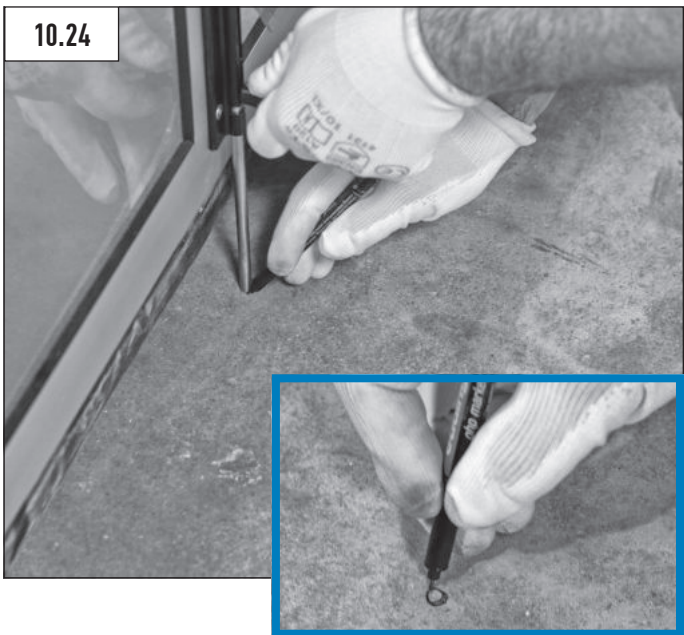
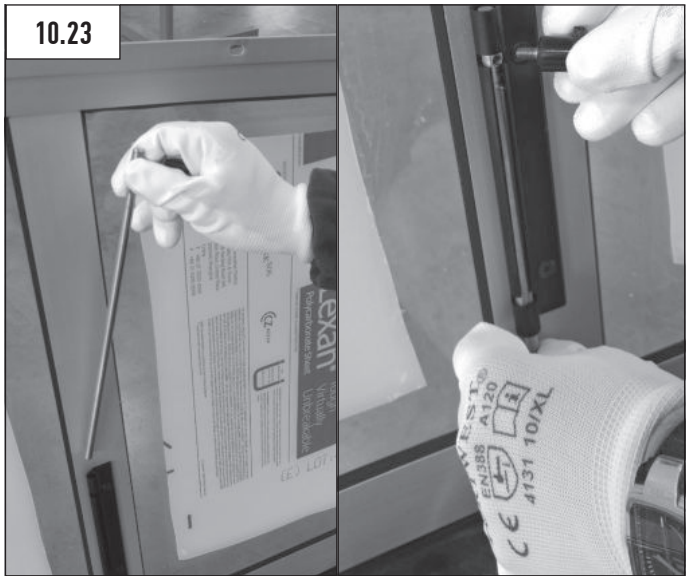
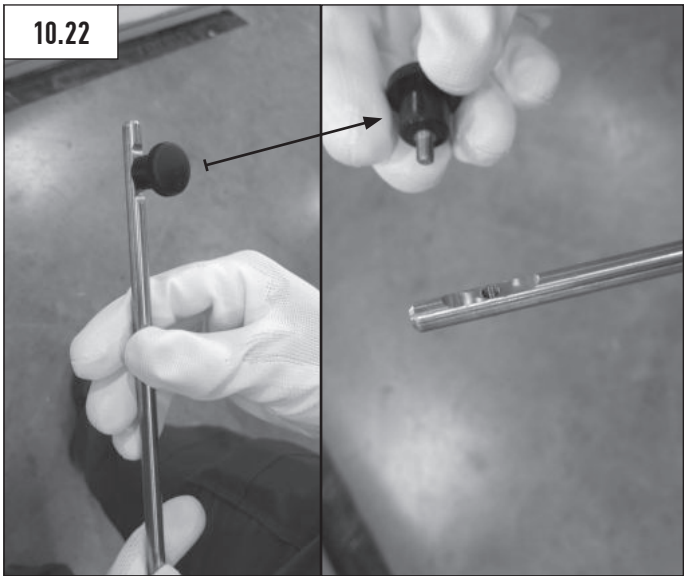
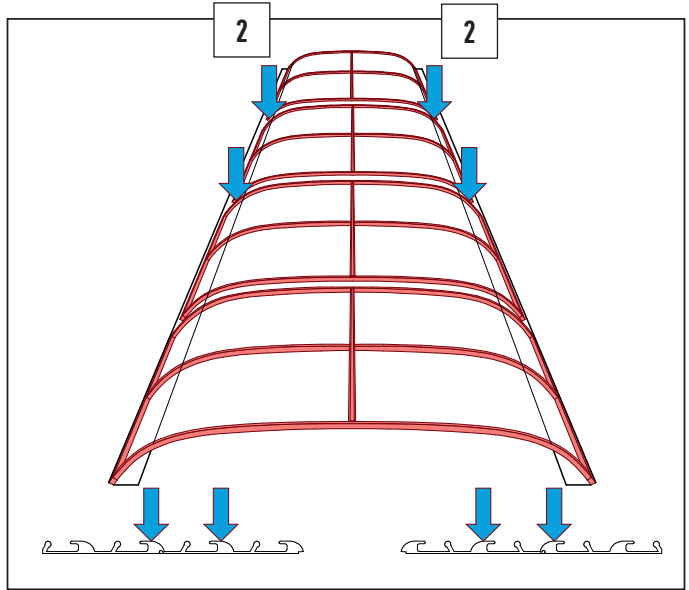

# 10 SLUTMONTERING

